

CLIENT: DEPARTMENT OF LOCAL BODIES & NAGAR PALIKA SADULSHAHAR

PROJECT NAME: FSTP- SADULSHAHAR

LOCATION: SADULSHAHAR, RAJASTHAN

Faecal Sludge Treatment Plant

NOTES

1. All dimensions are in 'mm' unless mentioned otherwise.
 2. All dimensions are checked and co-related with the architectural drawings and any discrepancy or omission shall be brought to the notice.
 3. This is the property of BORDA/CDD & is not to be copied or produced anywhere without their permission.
 4. The structural component and BOQ prepared considering Existing Ground Level (+98.25)
 5. EGL = Existing Ground Level +98.25
 6. FGL = Finished Ground Level
 7. HFL = High Flood Level
 8. IL/OL = Inlet level/Outlet Level.
- Cement (SRC).
 10.'R' indicates Register;
 'PDB' indicates Planted Drying Bed
 'UPDB' indicates Unplanted Drying Bed
 'AF' indicates Anaerobic Filter;
 'PGF' indicates Planted Gravel Filter;
 'CT' indicates Collection Tank
 11. Use UPVC pipes (55mm, 110mm & 150 mm dia (2", 4" & 6")) which can withstand pressure of 6kg/cm².
 12. Bench Mark = As per the layout plan provided
 13. Plastering is not considered for the RCC wall structures of PDB, UPDB and Registers
 14. For the details on dimensions of any modules and structures refer to structural drawings. In case of conflict related to dimensions and specifications, structural drawings shall supersede the hydraulic or architectural drawings.

REVISIONS

DATE	REMARKS	SIGNATURE

TITLE
COVER PAGE-FSTP Sadulshahar

DRG. No.
SDL-FSTP-CS (Dwg 01 of 21)

PROJECT NAME
FSTP- Sadul shahar, Rajasthan

CLIENT:
DLB- Rajasthan and Nagar Palika
Sadul shahar

CLIENTS CONSULTANT:

 Consortium for
DEWATS
Dissemination
Society
 Survey No.215,
Opp. Beedi Workers Colony,
Kommaghatta Road, Bandemath
BANGALORE - 560 060
KARNATAKA.

DRAWN BY	CHECKED BY	APPROVED BY
Nithin A.	Praveen N.	Praveen N.
DATE	DATE	DATE
21-02-2121	21-02-2121	21-02-2121
SCALE: NTP	SHEET 01 OF 21 SHEETS	

INDEX TO DRAWINGS

SHT NO.	DWG NO.	DESCRIPTION
01	SDL-FSTP-CS-(Dwg 01 of 21)	Cover page- FSTP Sadul shahar
02	SDL-FSTP-MP-01(Dwg 02 of 21)	Master Plan
03	SDL-FSTP-MP-02(Dwg 03 of 21)	Master Plan
04	SDL-FSTP-HP-01(Dwg 04 of 21)	Hydraulic Profile Drawing
05	SDL-FSTP-HD-SC-01(Dwg 05 of 21)	Screening chamber: Plan, Section and bar screen details
06	SDL-FSTP-HD-PDB-01(Dwg 06 of 21)	Planted Drying Beds: Section CC & Sectional plan
07	SDL-FSTP-HD-PDB-02(Dwg 07 of 21)	Planted Drying Beds: Cross Section AA & BB
08	SDL-FSTP-HD-ISAF-01(Dwg 08 of 21)	Integrated settler+AF: Sectional Plan & Cross section AA
09	SDL-FSTP-HD-ISAF-02(Dwg 09 of 21)	Integrated settler+AF: Section BB, Manhole layout with perforated slab details
10	SDL-FSTP-HD-PGF-01(Dwg 10 of 21)	Planted Gravel Filter: Sectional Plan & Sections AA & BB
11	SDL-FSTP-HD-PP-01(Dwg 11 of 21)	Polishing Pond: Plan
12	SDL-FSTP-HD-PP-02(Dwg 12 of 21)	Polishing Pond: Section AA & BB
13	SDL-FSTP-OR-01(Dwg 13 of 21)	Operator Room: Elevation, Section & Plan
14	SDL-FSTP-GR-01(Dwg 14 of 21)	Guard Room: Elevation, Section & Plan
15	SDL-FSTP-CD-SSY-01(Dwg 15 of 21)	Sludge Storage Yard: Section , Plan & foundation details
16	SDL-FSTP-CD-RD-01(Dwg 16 of 21)	Bituminous road: Typical Section
17	SDL-FSTP-CD-REG-01(Dwg 17 of 21)	Registers: Sections
18	SDL-FSTP-CD-CW-01(Dwg 18 of 21)	Compound wall: Section
19	SDL-FSTP-CD-CW-02(Dwg 19 of 21)	Compound wall: Plan
20	SDL-FSTP-CD-EMB-01(Dwg 20 of 21)	Ramp Embankment: Section
21	SDL-FSTP-TOPO-01(Dwg 21 of 21)	Topography map- FSTP site- Sadulshahar

VICINITY MAP



LOCATION MAP

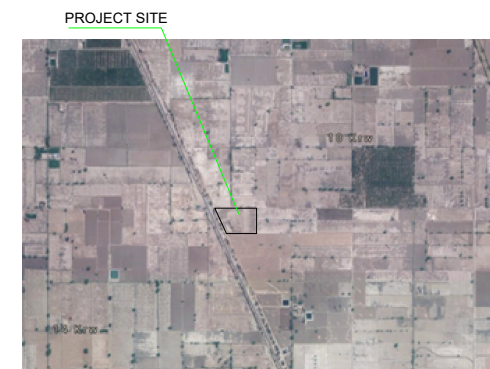

GPS CO-ORDINATES: 29°52'54.38"N 74°11'54.29"E

LEGENDS/SYMBOLS

<table style="width: 100%; border-collapse: collapse;"> <tr><td style="text-align: center;"></td><td>GATE VALVE</td></tr> <tr><td style="text-align: center;"></td><td>MAN HOLE</td></tr> <tr><td style="text-align: center;"></td><td>PIPE</td></tr> <tr><td style="text-align: center;"></td><td>GAS VENT OPENING</td></tr> <tr><td style="text-align: center;"></td><td>RCC WALL</td></tr> <tr><td style="text-align: center;"></td><td>BRICK WALL</td></tr> <tr><td style="text-align: center;"></td><td>CINDERS</td></tr> <tr><td style="text-align: center;"></td><td>SOLING</td></tr> <tr><td style="text-align: center;"></td><td>CEMENT CONCRETE FILLING</td></tr> </table>		GATE VALVE		MAN HOLE		PIPE		GAS VENT OPENING		RCC WALL		BRICK WALL		CINDERS		SOLING		CEMENT CONCRETE FILLING	<table style="width: 100%; border-collapse: collapse;"> <tr><td style="text-align: center;"></td><td>SUPPORT WALL</td></tr> <tr><td style="text-align: center;"></td><td>SECTION OF A-A</td></tr> <tr><td style="text-align: center;"></td><td>V-NOTCH</td></tr> <tr><td style="text-align: center;"></td><td>WATER LEVEL</td></tr> <tr><td style="text-align: center;"></td><td>EXISTING GROUND LEVEL</td></tr> <tr><td style="text-align: center;"></td><td>GAS VENT PIPE WITH VENT COWL</td></tr> <tr><td style="text-align: center;"></td><td>S.S OPEN CHANNEL GATE</td></tr> <tr><td style="text-align: center;"></td><td>OPENING IN WALL</td></tr> <tr><td style="text-align: center;"></td><td>LANDSCAPE</td></tr> </table>		SUPPORT WALL		SECTION OF A-A		V-NOTCH		WATER LEVEL		EXISTING GROUND LEVEL		GAS VENT PIPE WITH VENT COWL		S.S OPEN CHANNEL GATE		OPENING IN WALL		LANDSCAPE
	GATE VALVE																																				
	MAN HOLE																																				
	PIPE																																				
	GAS VENT OPENING																																				
	RCC WALL																																				
	BRICK WALL																																				
	CINDERS																																				
	SOLING																																				
	CEMENT CONCRETE FILLING																																				
	SUPPORT WALL																																				
	SECTION OF A-A																																				
	V-NOTCH																																				
	WATER LEVEL																																				
	EXISTING GROUND LEVEL																																				
	GAS VENT PIPE WITH VENT COWL																																				
	S.S OPEN CHANNEL GATE																																				
	OPENING IN WALL																																				
	LANDSCAPE																																				

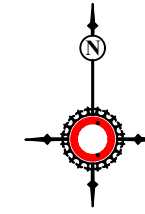

Faecal Sludge Treatment Plant

NOTES

1. All dimensions are in 'mm' unless mentioned otherwise.
2. All dimensions are checked and co-related with the architectural drawings and any discrepancy or omission shall be brought to the notice.
3. This is the property of BORDA/CDD & is not to be copied or produced anywhere without their permission.
4. The structural component and BOQ prepared considering Existing Ground Level (+98.25)
5. EGL = Existing Ground Level +98.25
6. FGL = Finished Ground Level
7. HFL = High Flood Level
8. IL/OL = Inlet level/Outlet Level.
9. Cement (SRC).
10. 'R' indicates Register;
11. 'PDB' indicates Planted Drying Bed
12. 'UPDB' indicates Unplanted Drying Bed
13. 'AF' indicates Anaerobic Filter;
14. 'PGF' indicates Planted Gravel Filter;
15. 'CT' indicates Collection Tank
16. Use UPVC pipes (65mm, 110mm & 150 mm dia (2", 4" & 6")) which can withstand pressure of 6kg/cm².
17. Bench Mark = As per the layout plan provided
18. Plastering is not considered for the RCC wall structures of PDB, UPDB and Registers
19. For the details on dimensions of any modules and structures refer to structural drawings. In case of conflict related to dimensions and specifications, structural drawings shall supersede the hydraulic or architectural drawings.

REVISIONS

DATE	REMARKS	SIGNATURE

TITLE
Master Plan

DRG. No.
SDL-FSTP-MP-01(Dwg 02 of 21)

PROJECT NAME
FSTP- Sadul shahar, Rajasthan

CLIENT:
DLB- Rajasthan and Nagar Palika Sadul shahar

CLIENTS CONSULTANT:

Consortium for
DEWATS
Dissemination
Society

Survey No.215,
Opp. Beedi Workers Colony,
Kommaghatta Road, Bandemath
BANGALORE - 560 060
KARNATAKA.

DRAWN BY	CHECKED BY	APPROVED BY
Nithin A.	Praveen N.	Praveen N.

DATE	DATE	DATE
21-02-2121	21-02-2121	21-02-2121

SCALE: NTP **SHEET** 02 **OF** 21 **SHEETS**

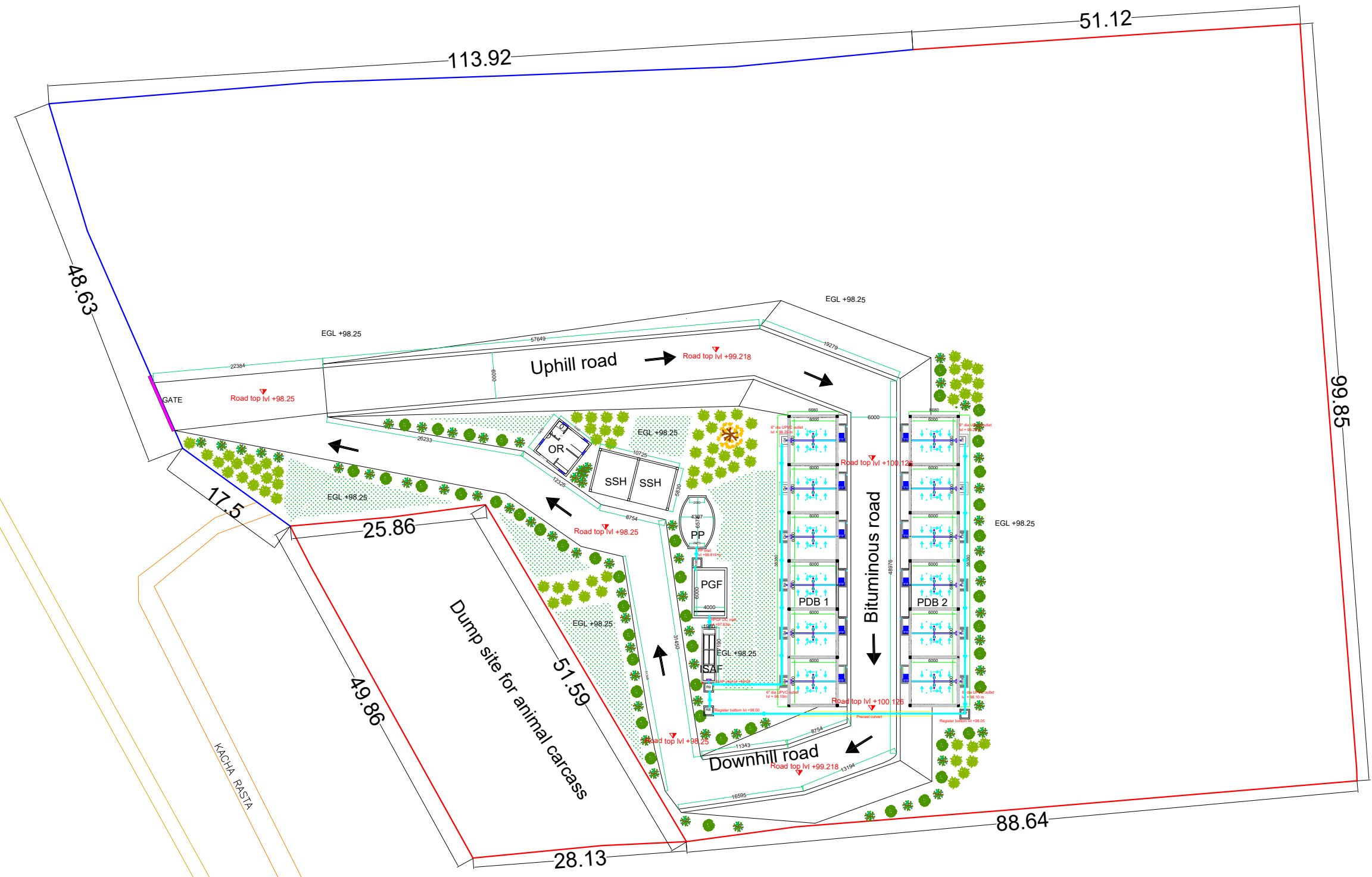

SDL SHAHAR

KACHA RASTA

TO HAM

Faecal Sludge Treatment Plant

NOTES

- All dimensions are in 'mm' unless mentioned otherwise.
- All dimensions are checked and co-related with the architectural drawings and any discrepancy or omission shall be brought to the notice.
- This is the property of BORDA/CDD & is not to be copied or produced anywhere without their permission.
- The structural component and BOQ prepared considering Existing Ground Level (+98.25)
- EGL = Existing Ground Level +98.25
- FGL = Finished Ground Level
- HFL = High Flood Level
- IL/OL = Inlet level/Outlet Level.
-
-
- Cement (SRC).
- 'R' indicates Register;
- 'PDB' indicates Planted Drying Bed
- 'UPDB' indicates Unplanted Drying Bed
- 'AF' indicates Anaerobic Filter;
- 'PGF' indicates Planted Gravel Filter;
- 'CT' indicates Collection Tank
- Use UPVC pipes (55mm, 110mm & 150 mm dia (2", 4" & 6")) which can withstand pressure of 6kg/cm².
- Bench Mark = As per the layout plan provided
- Plastering is not considered for the RCC wall structures of PDB, UPDB and Registers
- For the details on dimensions of any modules and structures refer to structural drawings. In case of conflict related to dimensions and specifications, structural drawings shall supersede the hydraulic or architectural drawings.

REVISIONS

DATE	REMARKS	SIGNATURE

TITLE

Master Plan

DRG. No.

SDL-FSTP-MP-02(Dwg 03 of 21)

PROJECT NAME

FSTP- Sadul shahar, Rajasthan

CLIENT:

DLB- Rajasthan and Nagar Palika Sadul shahar

CLIENTS CONSULTANT:

 Consortium for DEWATS Dissemination Society
Survey No.215,
Opp. Beedi Workers Colony,
Kommaghatta Road, Bandemath
BANGALORE - 560 060
KARNATAKA.

DRAWN BY	CHECKED BY	APPROVED BY
Nithin A.	Praveen N.	Praveen N.

DATE	DATE	DATE
21-02-2121	21-02-2121	21-02-2121

SCALE:NTP	SHEET 03 OF 21 SHEETS

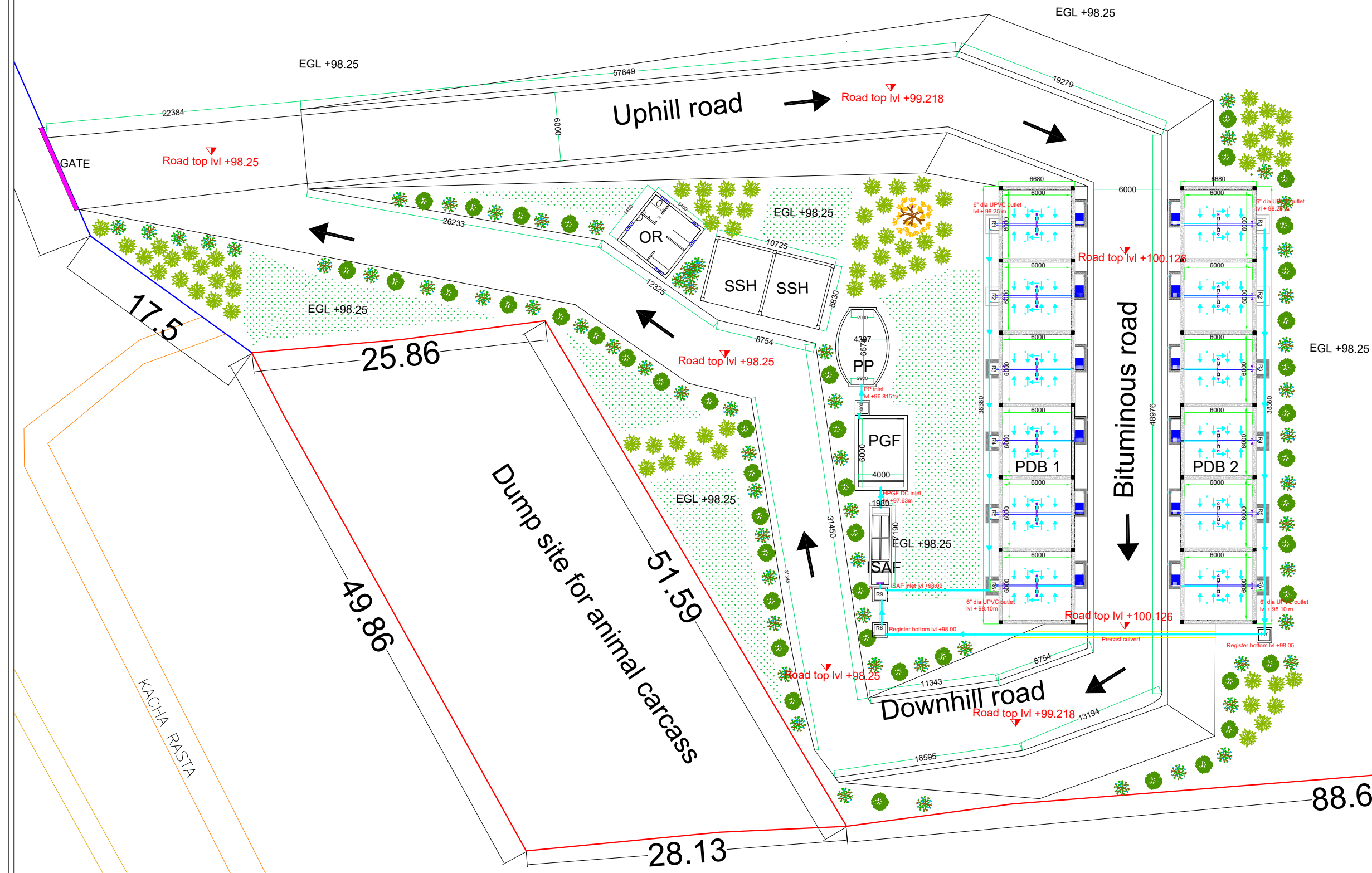

Faecal Sludge Treatment Plant

NOTES

- All dimensions are in 'mm' unless mentioned otherwise.
 - All dimensions are checked and co-related with the architectural drawings and any discrepancy or omission shall be brought to the notice.
 - This is the property of BORDA/CDD & is not to be copied or produced anywhere without their permission.
 - The structural component and BOQ prepared considering Existing Ground Level (+98.25)
 - EGL = Existing Ground Level +98.25
 - FGL = Finished Ground Level
 - HFL = High Flood Level
 - IL/OL = Inlet/Outlet Level.
9. Cement (SRC).
10. 'R' indicates Register;
 'PDB' indicates Planted Drying Bed
 'UPDB' indicates Unplanted Drying Bed
 'AF' indicates Anaerobic Filter;
 'PGF' indicates Planted Gravel Filter;
 'CT' indicates Collection Tank
11. Use UPVC pipes (55mm, 110mm & 150 mm dia (2", 4" & 6")) which can withstand pressure of 6kg/cm².
12. Bench Mark = As per the layout plan provided
13. Plastering is not considered for the RCC wall structures of PDB, UPDB and Registers
14. For the details on dimensions of any modules and structures refer to structural drawings. In case of conflict related to dimensions and specifications, structural drawings shall supersede the hydraulic or architectural drawings.

REVISIONS

DATE	REMARKS	SIGNATURE

TITLE
Hydraulic Profile Drawing

DRG. No.
SDL-FSTP-HP-01(Dwg 04 of 21)

PROJECT NAME
FSTP- Sadul shahar, Rajasthan

CLIENT:
DLB- Rajasthan and Nagar Palika
Sadul shahar

CLIENTS CONSULTANT:
 Consortium for DEWATS Dissemination Society
 Survey No.215,
 Opp. Beedi Workers Colony,
 Kommaghatta Road, Bandemath
 BANGALORE - 560 060
 KARNATAKA.

DRAWN BY	CHECKED BY	APPROVED BY
Nithin A.	Praveen N.	Praveen N.
DATE	DATE	DATE
21-02-2121	21-02-2121	21-02-2121
SCALE: NTP	SHEET 04 OF 21 SHEETS	

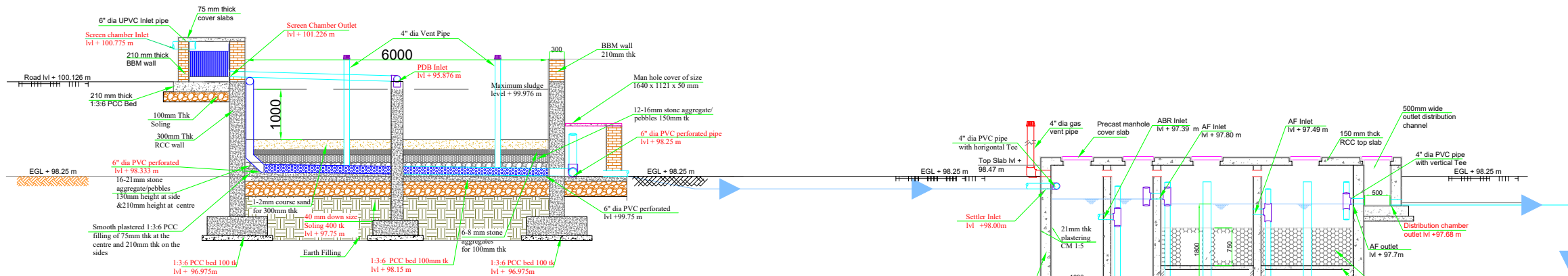

Planted Drying Bed

Integrated Settler and Anaerobic Filters

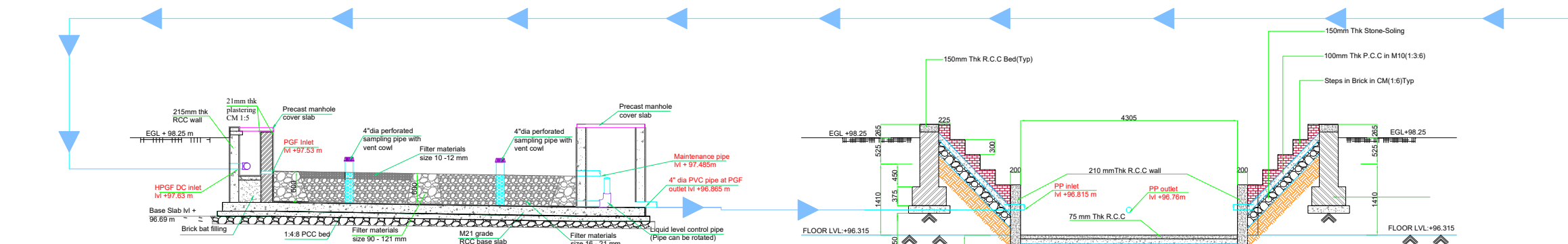

Planted Gravel Filter

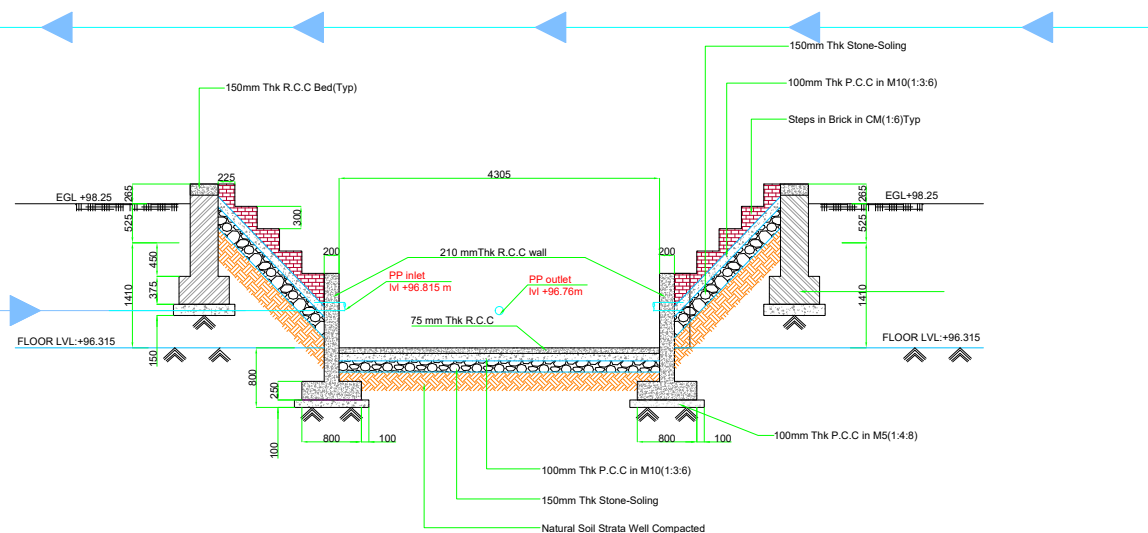

Polishing Pond

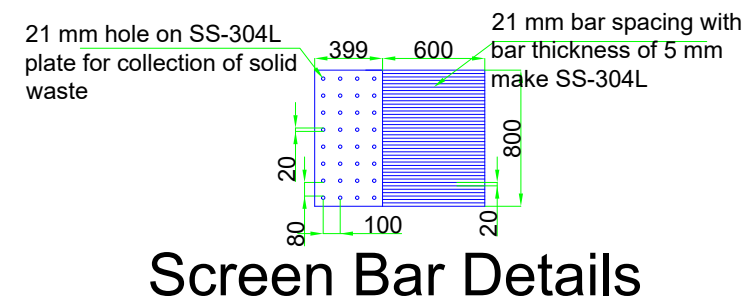
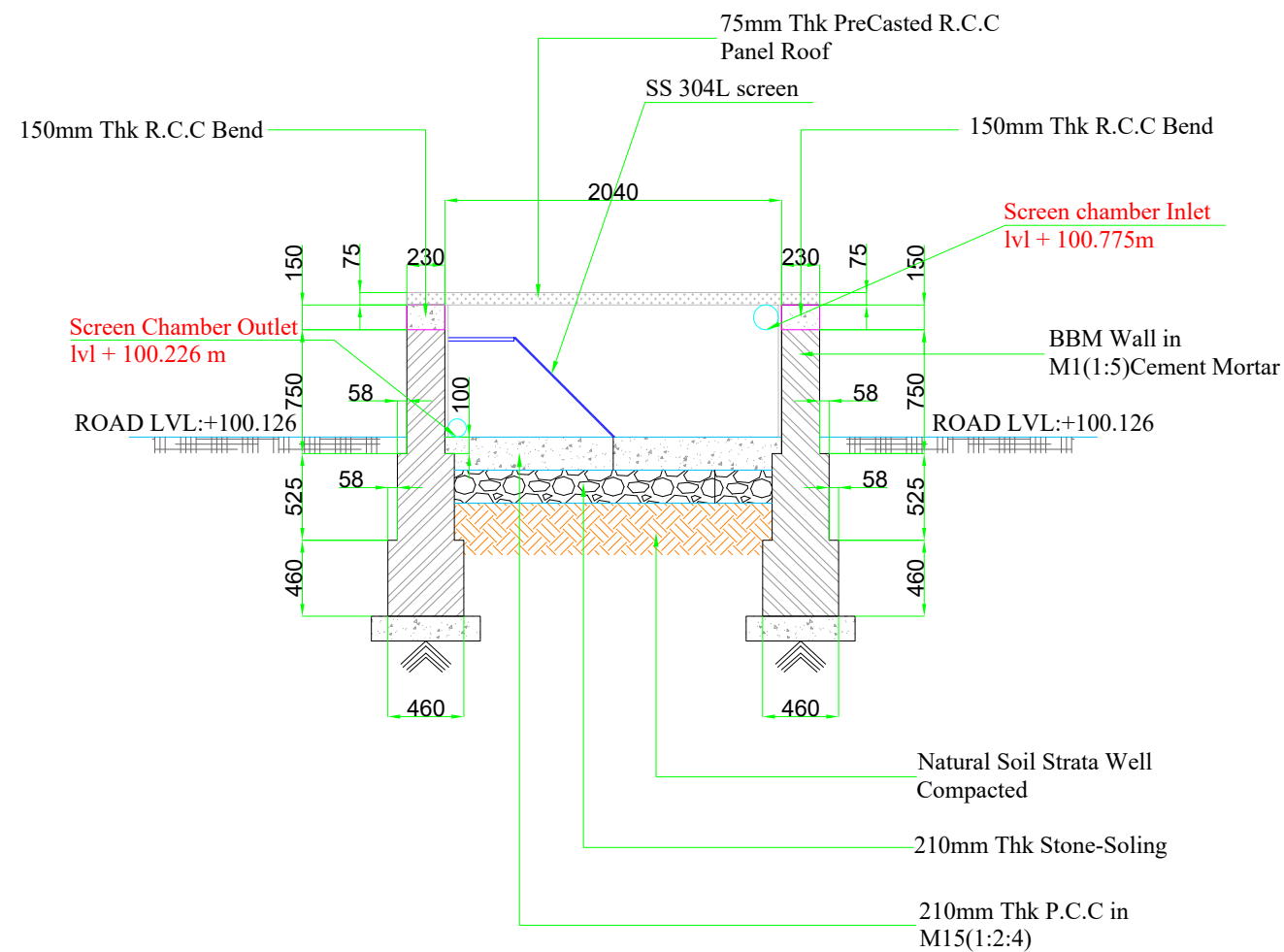
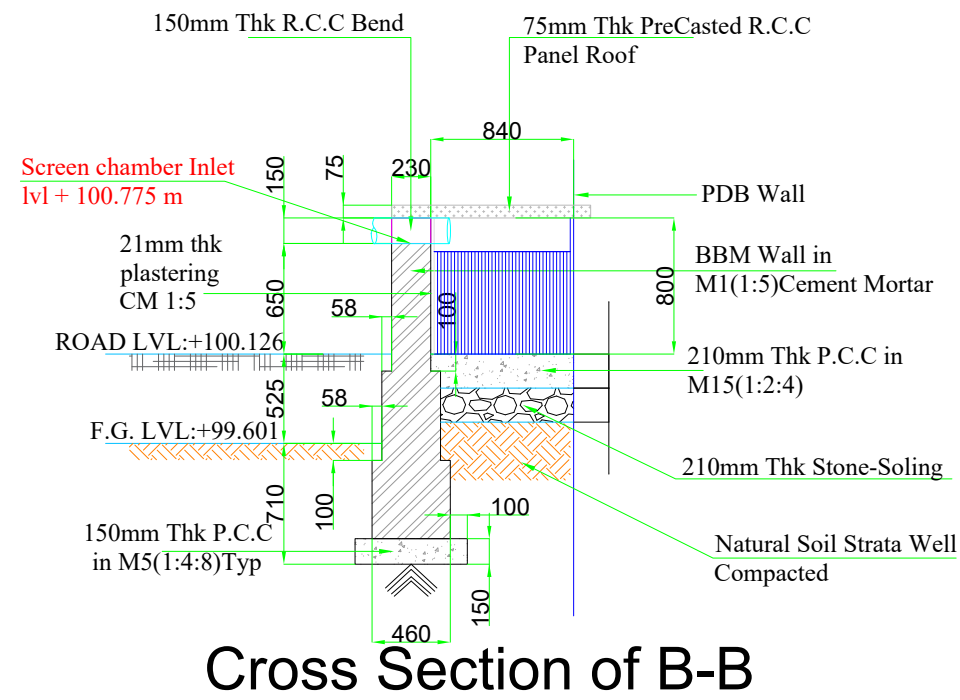
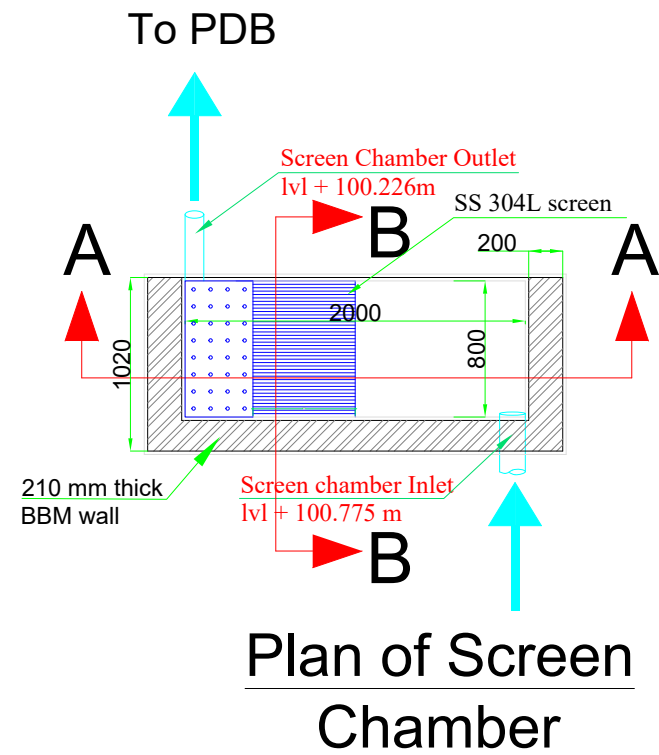

Faecal Sludge Treatment Plant

NOTES

- All dimensions are in 'mm' unless mentioned otherwise.
- All dimensions are checked and co-related with the architectural drawings and any discrepancy or omission shall be brought to the notice.
- This is the property of BORDA/CDD & is not to be copied or produced anywhere without their permission.
- The structural component and BOQ prepared considering Existing Ground Level (+98.25)
- EGL = Existing Ground Level +98.25
- FGL = Finished Ground Level
- HFL = High Flood Level
- IL/OL = Inlet level/Outlet Level.
- Cement (SRC).
- 'R' indicates Register;
- 'PDB' indicates Planted Drying Bed
- 'UPDB' indicates Unplanted Drying Bed
- 'AF' indicates Anaerobic Filter;
- 'PGF' indicates Planted Gravel Filter;
- 'CT' indicates Collection Tank
- Use UPVC pipes (55mm, 110mm & 150 mm dia (2", 4" & 6")) which can withstand pressure of 6kg/cm².
- Bench Mark = As per the layout plan provided
- Plastering is not considered for the RCC wall structures of PDB, UPDB and Registers
- For the details on dimensions of any modules and structures refer to structural drawings. In case of conflict related to dimensions and specifications, structural drawings shall supersede the hydraulic or architectural drawings.

REVISIONS

DATE	REMARKS	SIGNATURE

TITLE
Screening Chamber: Plan, Sections and Bar screen details

DRG. No.
SDL-FSTP-HD-SC-01(Dwg 05 of 21)

PROJECT NAME
FSTP- Sadul shahar, Rajasthan

CLIENT:
DLB- Rajasthan and Nagar Palika
Sadul shahar

CLIENTS CONSULTANT:
 Consortium for DEWATS Dissemination Society
 Survey No.215,
 Opp. Beedi Workers Colony,
 Kommaghatta Road, Bandemath
 BANGALORE - 560 060
 KARNATAKA.

DRAWN BY	CHECKED BY	APPROVED BY
Nithin A.	Praveen N.	Praveen N.
DATE	DATE	DATE
21-02-2121	21-02-2121	21-02-2121
SCALE: NTP	SHEET 05 OF 21 SHEETS	

Faecal Sludge Treatment Plant

NOTES

- All dimensions are in 'mm' unless mentioned otherwise.
- All dimensions are checked and co-related with the architectural drawings and any discrepancy or omission shall be brought to the notice.
- This is the property of BORDA/CDD & is not to be copied or produced anywhere without their permission.
- The structural component and BOQ prepared considering Existing Ground Level (+98.25)
- EGL = Existing Ground Level +98.25
- FGL = Finished Ground Level
- HFL = High Flood Level
- IL/OL = Inlet level/Outlet Level.

- Cement (SRC).
- 'R' indicates Register;
- 'PDB' indicates Planted Drying Bed
- 'UPDB' indicates Unplanted Drying Bed
- 'AF' indicates Anaerobic Filter;
- 'PGF' indicates Planted Gravel Filter;
- 'CT' indicates Collection Tank
- Use UPVC pipes (55mm, 110mm & 150 mm dia (2", 4" & 6")) which can withstand pressure of 6kg/cm².
- Bench Mark = As per the layout plan provided
- Plastering is not considered for the RCC wall structures of PDB, UPDB and Registers
- For the details on dimensions of any modules and structures refer to structural drawings. In case of conflict related to dimensions and specifications, structural drawings shall supersede the hydraulic or architectural drawings.

REVISIONS

DATE	REMARKS	SIGNATURE

TITLE
PLANTED DRYING BEDS: Section CC & Sectional Plan

DRG. No.
SDL-FSTP-HD-PDB-01(Dwg 06 of 21)

PROJECT NAME
FSTP- Sadul shahar, Rajasthan

CLIENT:
DLB- Rajasthan and Nagar Palika
Sadul shahar

CLIENTS CONSULTANT:
 Consortium for DEWATS Dissemination Society
 Survey No.215,
 Opp. Beedi Workers Colony,
 Kommaghatta Road, Bandemath
 BANGALORE - 560 060
 KARNATAKA.

DRAWN BY	CHECKED BY	APPROVED BY
Nithin A.	Praveen N.	Praveen N.
DATE	DATE	DATE
21-02-2121	21-02-2121	21-02-2121
SCALE: NTP	SHEET 06 OF 21 SHEETS	

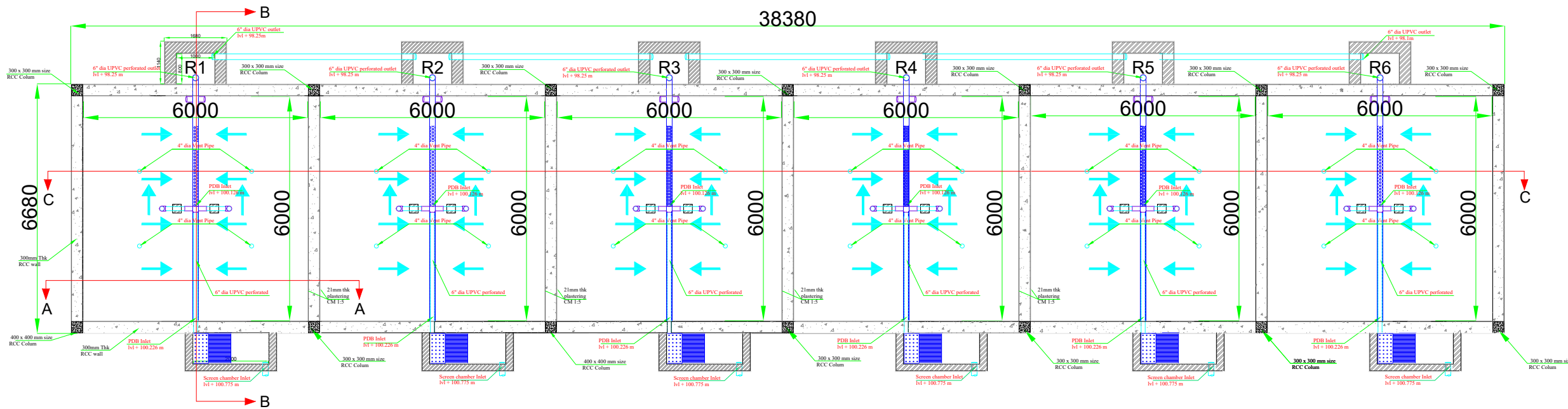

Plan of Planted Drying Bed

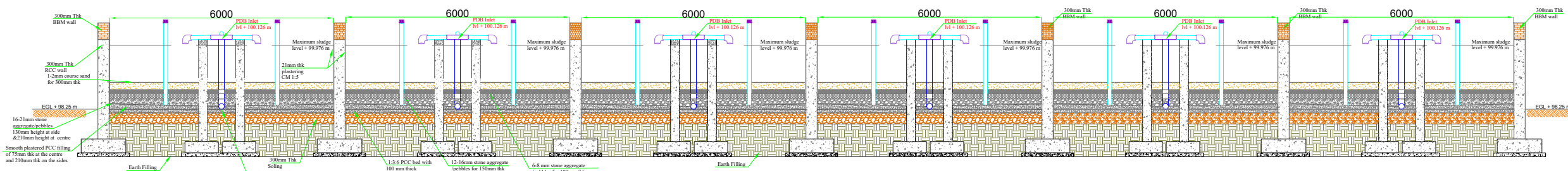

Cross Section of C-C

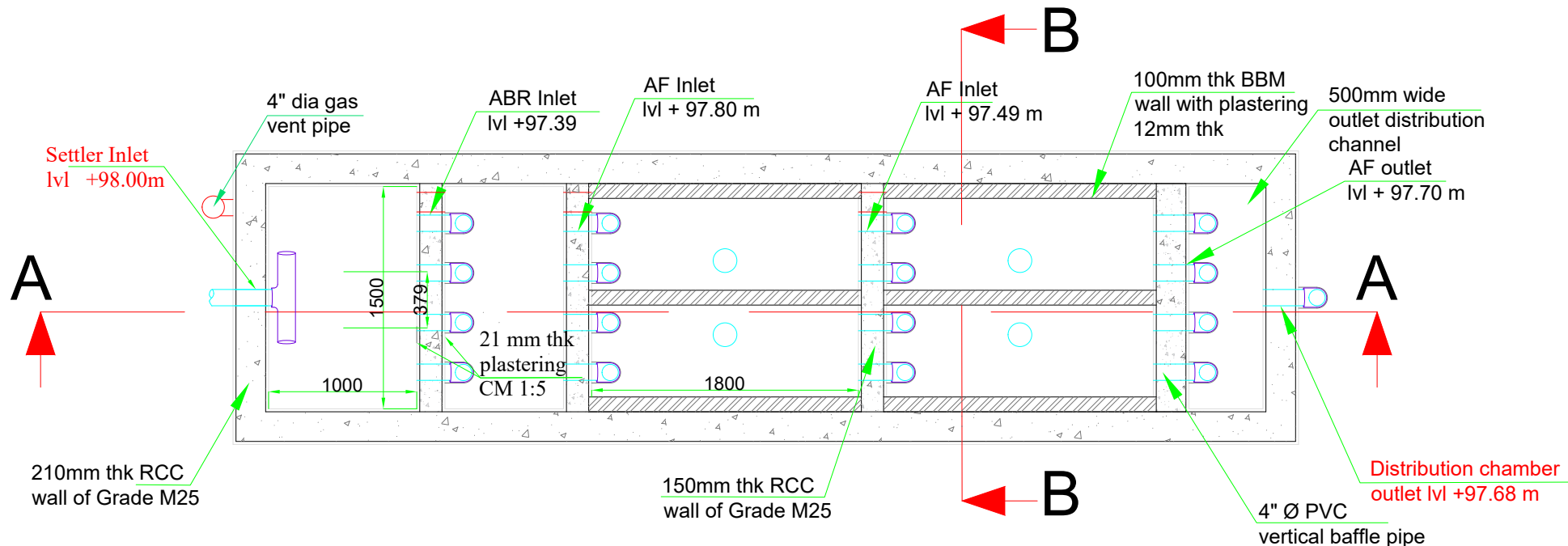

Plan of Integrated Settler and Anaerobic Filters

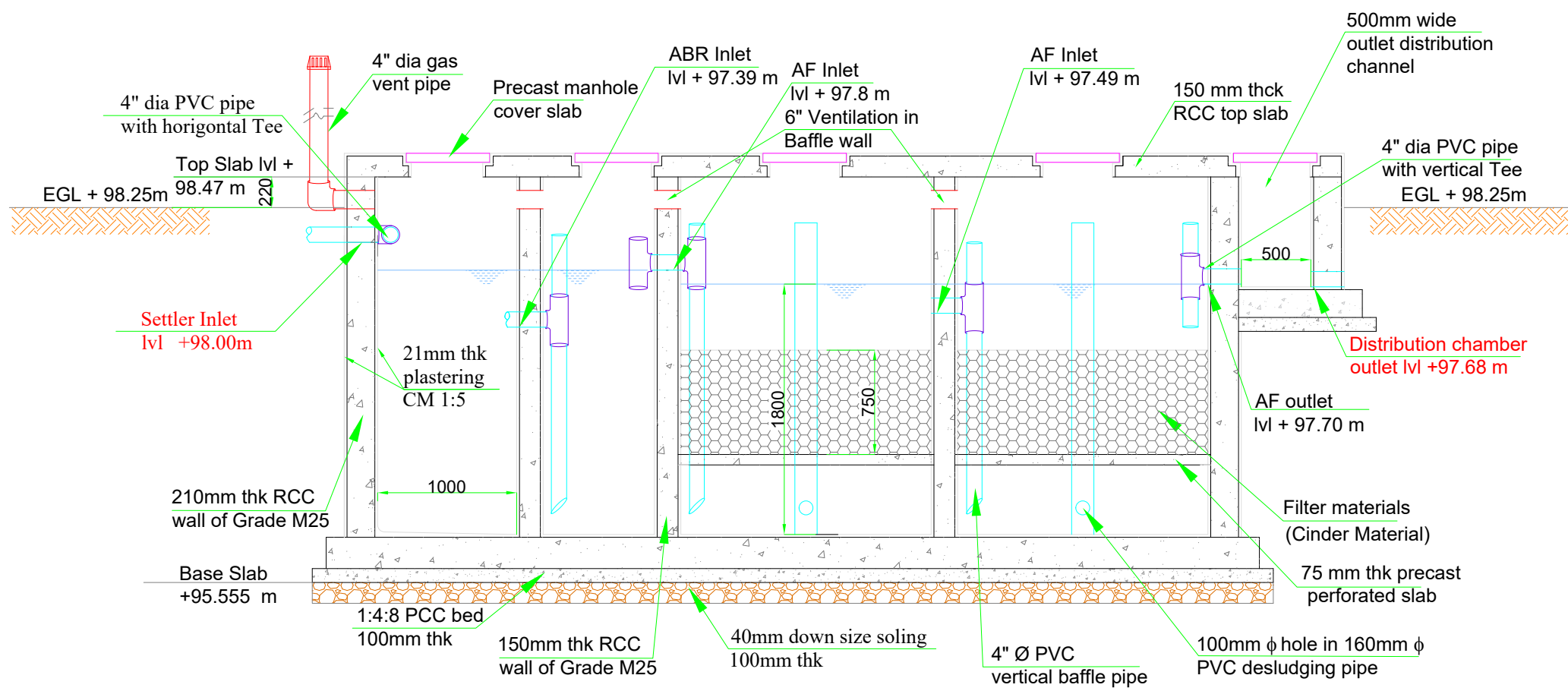

Cross section @ A-A

Faecal Sludge Treatment Plant

NOTES

- All dimensions are in 'mm' unless mentioned otherwise.
- All dimensions are checked and co-related with the architectural drawings and any discrepancy or omission shall be brought to the notice.
- This is the property of BORDA/CDD & is not to be copied or produced anywhere without their permission.
- The structural component and BOQ prepared considering Existing Ground Level (+98.25)
- EGL = Existing Ground Level +98.25
- FGL = Finished Ground Level
- HFL = High Flood Level
- IL/OL = Inlet level/Outlet Level.
- Cement (SRC).
- 'R' indicates Register;
- 'PDB' indicates Planted Drying Bed
- 'UPDB' indicates Unplanted Drying Bed
- 'AF' indicates Anaerobic Filter;
- 'PGF' indicates Planted Gravel Filter;
- 'CT' indicates Collection Tank
- Use UPVC pipes (55mm, 110mm & 150 mm dia (2", 4" & 6")) which can withstand pressure of 6kg/cm².
- Bench Mark = As per the layout plan provided
- Plastering is not considered for the RCC wall structures of PDB, UPDB and Registers
- For the details on dimensions of any modules and structures refer to structural drawings. In case of conflict related to dimensions and specifications, structural drawings shall supersede the hydraulic or architectural drawings.

REVISIONS

DATE	REMARKS	SIGNATURE

TITLE
INTEGRATED SETTLER+AF: Sectional plan & cross section AA

DRG. No.
SDL-FSTP-HD-ISAF-01(Dwg 08 of 21)

PROJECT NAME
FSTP- Sadul shahar, Rajasthan

CLIENT:
DLB- Rajasthan and Nagar Palika Sadul shahar

CLIENTS CONSULTANT:
 Consortium for DEWATS Dissemination Society
 Survey No.215, Opp. Beedi Workers Colony, Kommaghatta Road, Bandemath BANGALORE - 560 060 KARNATAKA.

DRAWN BY	CHECKED BY	APPROVED BY
Nithin A.	Praveen N.	Praveen N.
DATE	DATE	DATE
21-02-2121	21-02-2121	21-02-2121
SCALE: NTP	SHEET 08 OF 21 SHEETS	

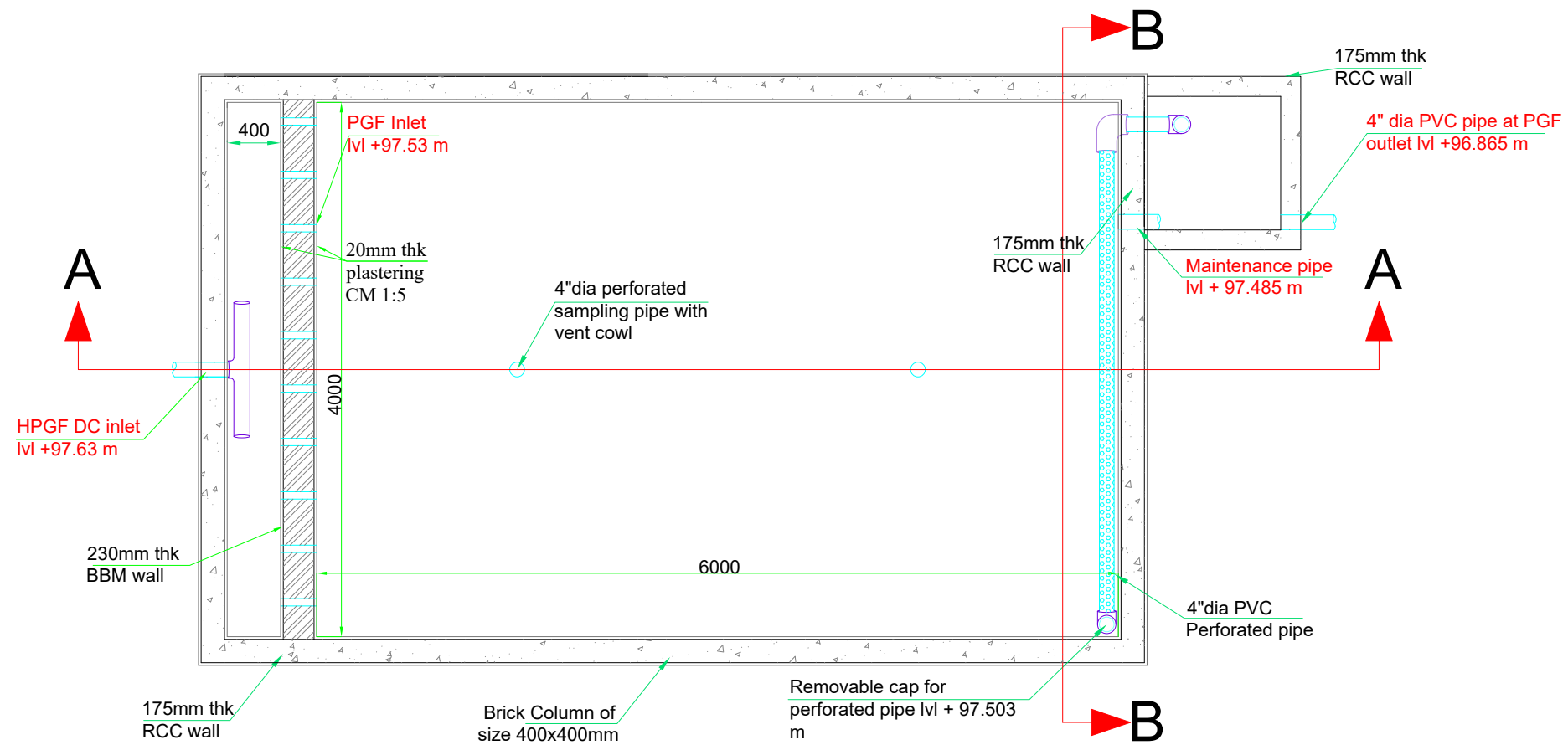

Plan of Planted Gravel Filter

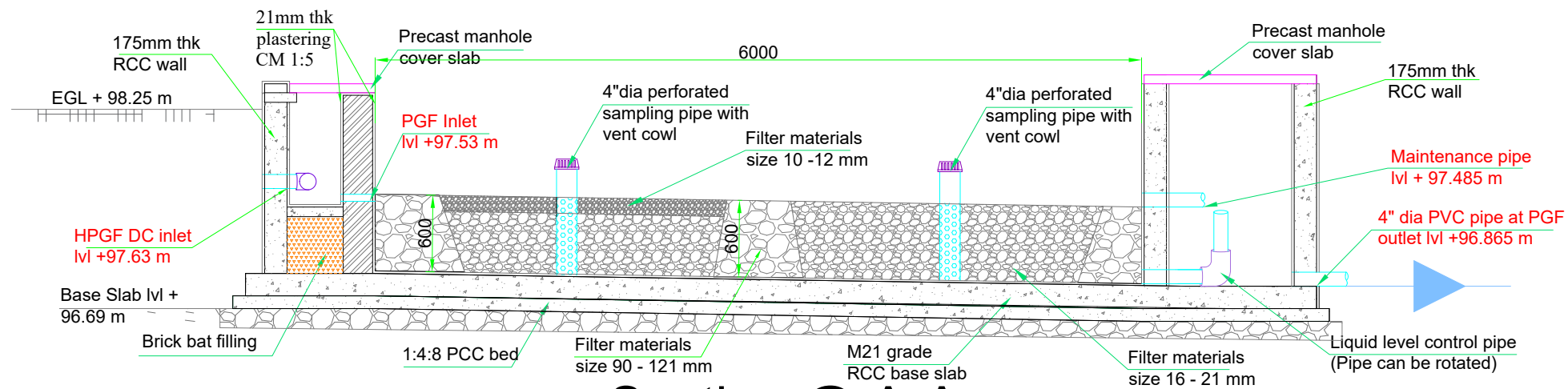

Section @ A-A

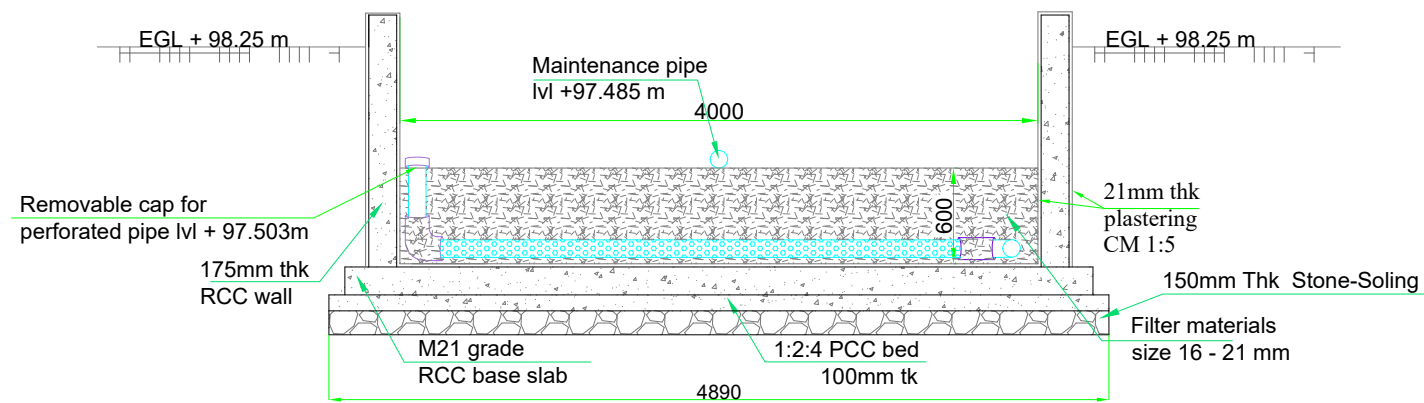

Section @ B-B

Faecal Sludge Treatment Plant

NOTES

- All dimensions are in 'mm' unless mentioned otherwise.
 - All dimensions are checked and co-related with the architectural drawings and any discrepancy or omission shall be brought to the notice.
 - This is the property of BORDA/CDD & is not to be copied or produced anywhere without their permission.
 - The structural component and BOQ prepared considering Existing Ground Level (+98.25)
 - EGL = Existing Ground Level +98.25
 - FGL = Finished Ground Level
 - HFL = High Flood Level
 - IL/OL = Inlet level/Outlet Level.
- Cement (SRC).
 10.'R' indicates Register;
 'PDB' indicates Planted Drying Bed
 'UPDB' indicates Unplanted Drying Bed
 'AF' indicates Anaerobic Filter;
 'PGF' indicates Planted Gravel Filter;
 'CT' indicates Collection Tank
 11. Use UPVC pipes (55mm, 110mm & 150 mm dia (2", 4" & 6")) which can withstand pressure of 6kg/cm².
 12. Bench Mark = As per the layout plan provided
 13. Plastering is not considered for the RCC wall structures of PDB, UPDB and Registers
 14. For the details on dimensions of any modules and structures refer to structural drawings. In case of conflict related to dimensions and specifications, structural drawings shall supersede the hydraulic or architectural drawings.

REVISIONS

DATE	REMARKS	SIGNATURE

TITLE
 PLANTED GRAVEL FILTER: Sectional plan & Section AA and BB

DRG. No.
 SDL-FSTP-HD-PGF-01(Dwg 10 of 21)

PROJECT NAME
 FSTP- Sadul shahar, Rajasthan

CLIENT:
 DLB- Rajasthan and Nagar Palika Sadul shahar

CLIENTS CONSULTANT:
 Consortium for DEWATS Dissemination Society
 Survey No.215, Opp. Beedi Workers Colony, Kommaghatta Road, Bandemath BANGALORE - 560 060 KARNATAKA.

DRAWN BY	CHECKED BY	APPROVED BY
Nithin A.	Praveen N.	Praveen N.
DATE	DATE	DATE
21-02-2121	21-02-2121	21-02-2121
SCALE: NTP	SHEET 10 OF 21 SHEETS	

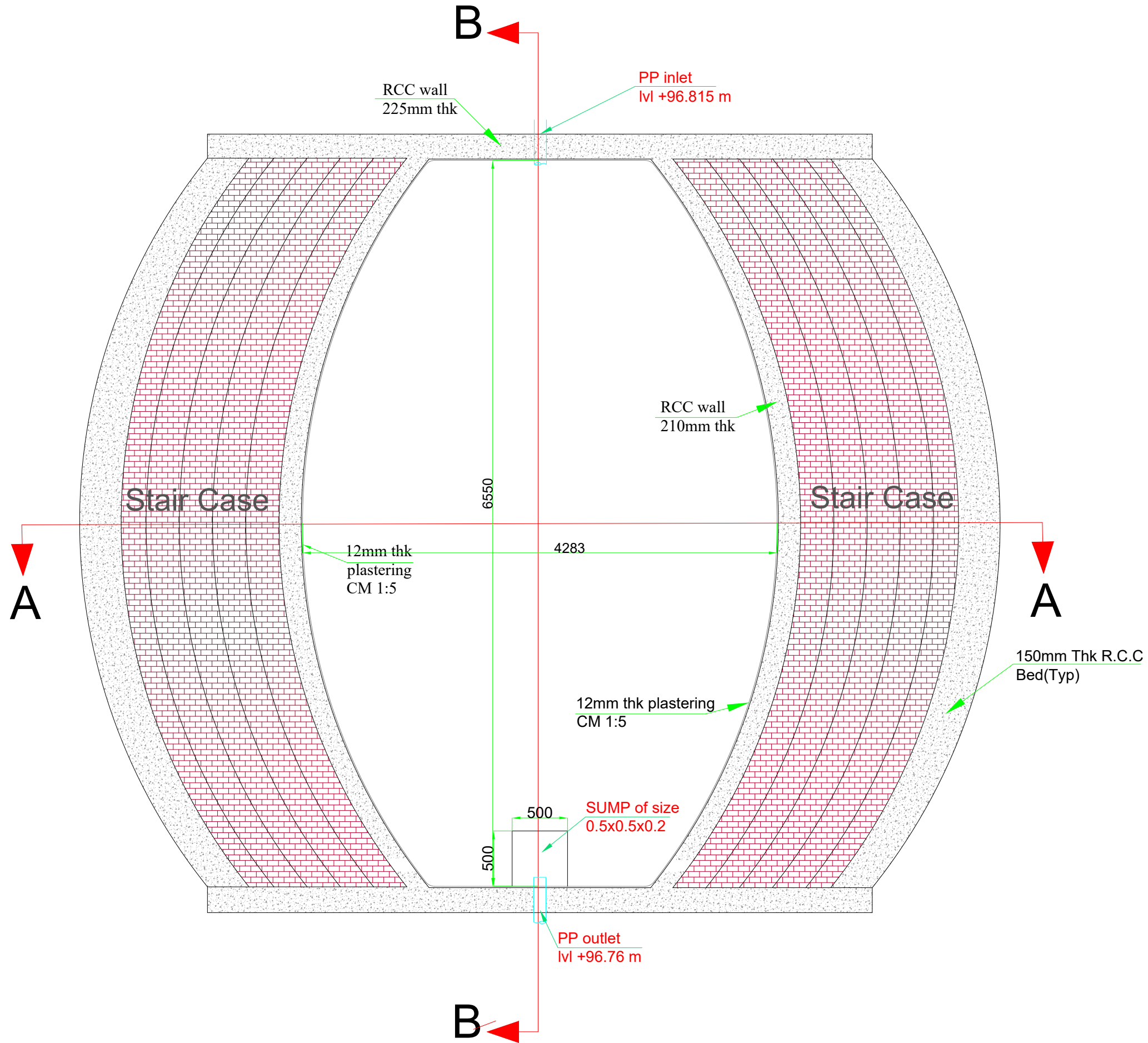

Plan of Polishing Pond

Faecal Sludge Treatment Plant

NOTES

- All dimensions are in 'mm' unless mentioned otherwise.
- All dimensions are checked and co-related with the architectural drawings and any discrepancy or omission shall be brought to the notice.
- This is the property of BORDA/CDD & is not to be copied or produced anywhere without their permission.
- The structural component and BOQ prepared considering Existing Ground Level (+98.25)
- EGL = Existing Ground Level +98.25
- FGL = Finished Ground Level
- HFL = High Flood Level
- IL/OL = Inlet level/Outlet Level.
- Cement (SRC).
- 'R' indicates Register.
- 'PDB' indicates Planted Drying Bed
- 'UPDB' indicates Unplanted Drying Bed
- 'AF' indicates Anaerobic Filter.
- 'PGF' indicates Planted Gravel Filter.
- 'CT' indicates Collection Tank
- Use UPVC pipes (55mm, 110mm & 150 mm dia (2", 4" & 6")) which can withstand pressure of 6kg/cm².
- Bench Mark = As per the layout plan provided
- Plastering is not considered for the RCC wall structures of PDB, UPDB and Registers
- For the details on dimensions of any modules and structures refer to structural drawings. In case of conflict related to dimensions and specifications, structural drawings shall supersede the hydraulic or architectural drawings.

REVISIONS

DATE	REMARKS	SIGNATURE

TITLE
POLISHING POND: Plan

DRG. No.
SDL-FSTP-HD-PP-01(Dwg 11 of 21)

PROJECT NAME
FSTP- Sadul shahar, Rajasthan

CLIENT:
DLB- Rajasthan and Nagar Palika Sadul shahar

CLIENTS CONSULTANT:
 Consortium for DEWATS Dissemination Society
 Survey No.215, Opp. Beedi Workers Colony, Kormmaghatta Road, Bandemath BANGALORE - 560 060 KARNATAKA.

DRAWN BY	CHECKED BY	APPROVED BY
Nithin A.	Praveen N.	Praveen N.
DATE	DATE	DATE
21-02-2121	21-02-2121	21-02-2121
SCALE: NTP	SHEET 11 OF 21 SHEETS	

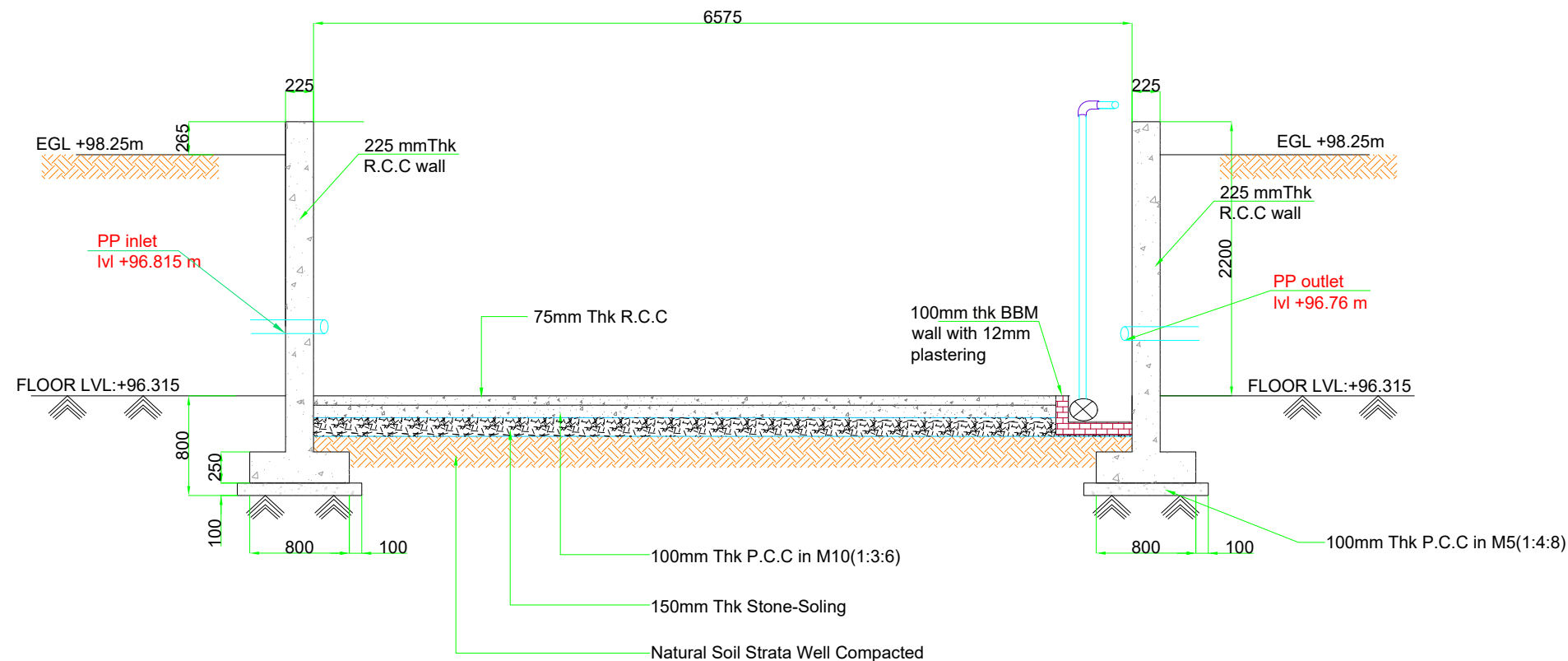

Cross Section of B-B

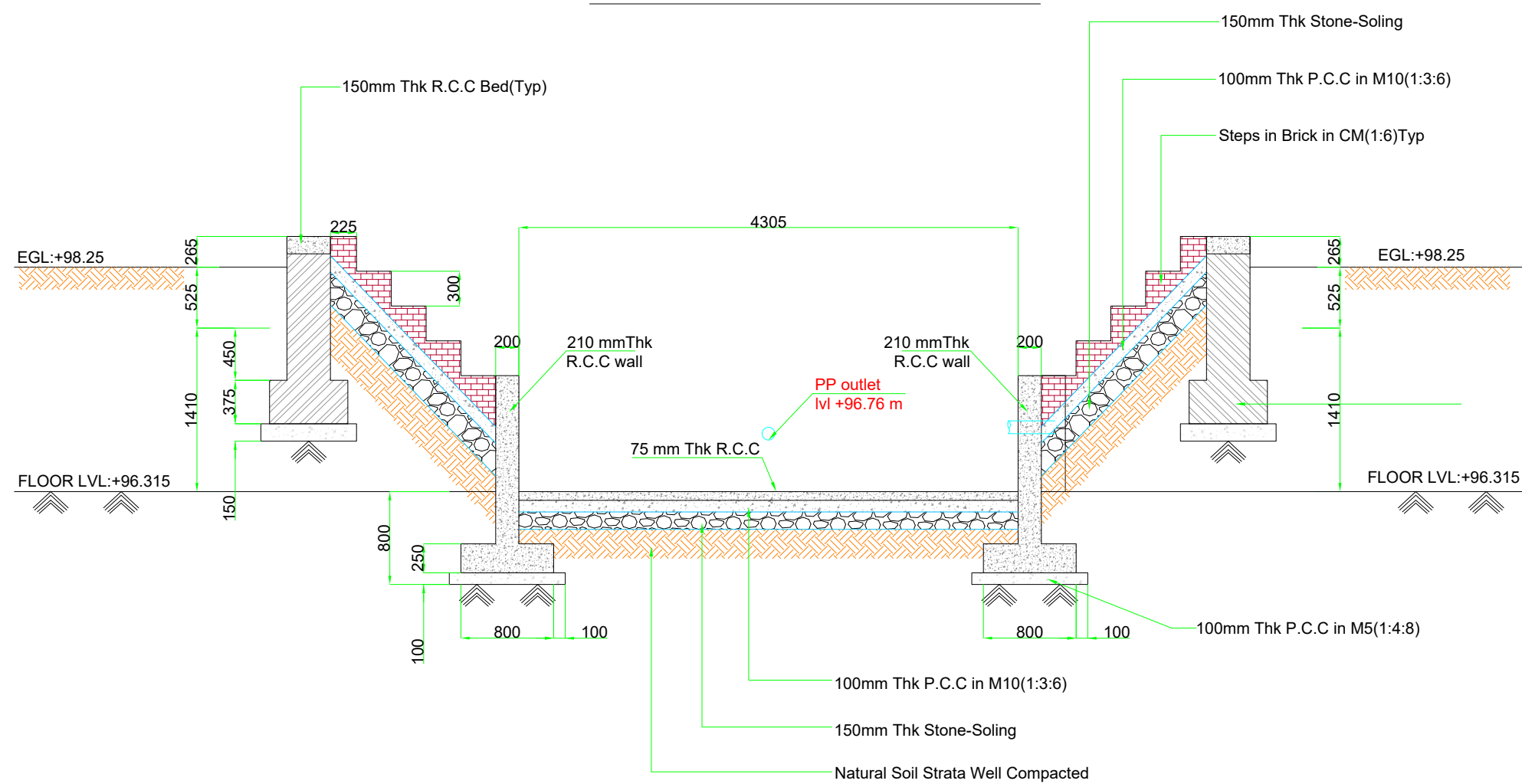

Cross Section of A-A

Faecal Sludge Treatment Plant

NOTES

- All dimensions are in 'mm' unless mentioned otherwise.
- All dimensions are checked and co-related with the architectural drawings and any discrepancy or omission shall be brought to the notice.
- This is the property of BORDA/CDD & is not to be copied or produced anywhere without their permission.
- The structural component and BOQ prepared considering Existing Ground Level (+98.25)
- EGL = Existing Ground Level +98.25
- FGL = Finished Ground Level
- HFL = High Flood Level
- I/L/O L = Inlet level/Outlet Level.
- Cement (SRC).
- 'R' indicates Register;
- 'PDB' indicates Planted Drying Bed
- 'UPDB' indicates Unplanted Drying Bed
- 'AF' indicates Anaerobic Filter;
- 'PGF' indicates Planted Gravel Filter;
- 'CT' indicates Collection Tank
- Use UPVC pipes (55mm, 110mm & 150 mm dia (2", 4" & 6") which can withstand pressure of 6kg/cm².
- Bench Mark = As per the layout plan provided
- Plastering is not considered for the RCC wall structures of PDB, UPDB and Registers
- For the details on dimensions of any modules and structures refer to structural drawings. In case of conflict related to dimensions and specifications, structural drawings shall supersede the hydraulic or architectural drawings.

REVISIONS

DATE	REMARKS	SIGNATURE

TITLE
POLISHING POND: Sections AA and BB

DRG. No.
SDL-FSTP-HD-PP-02(Dwg 12 of 21)

PROJECT NAME
FSTP- Sadul shahar, Rajasthan

CLIENT:
DLB- Rajasthan and Nagar Palika
Sadul shahar

CLIENTS CONSULTANT:
 Consortium for DEWATS Dissemination Society
 Survey No.215,
 Opp. Beedi Workers Colony,
 Kammaghatta Road, Bandemath
 BANGALORE - 560 060
 KARNATAKA.

DRAWN BY	CHECKED BY	APPROVED BY
Nithin A.	Praveen N.	Praveen N.
DATE	DATE	DATE
21-02-2121	21-02-2121	21-02-2121
SCALE: NTP	SHEET 12 OF 21 SHEETS	

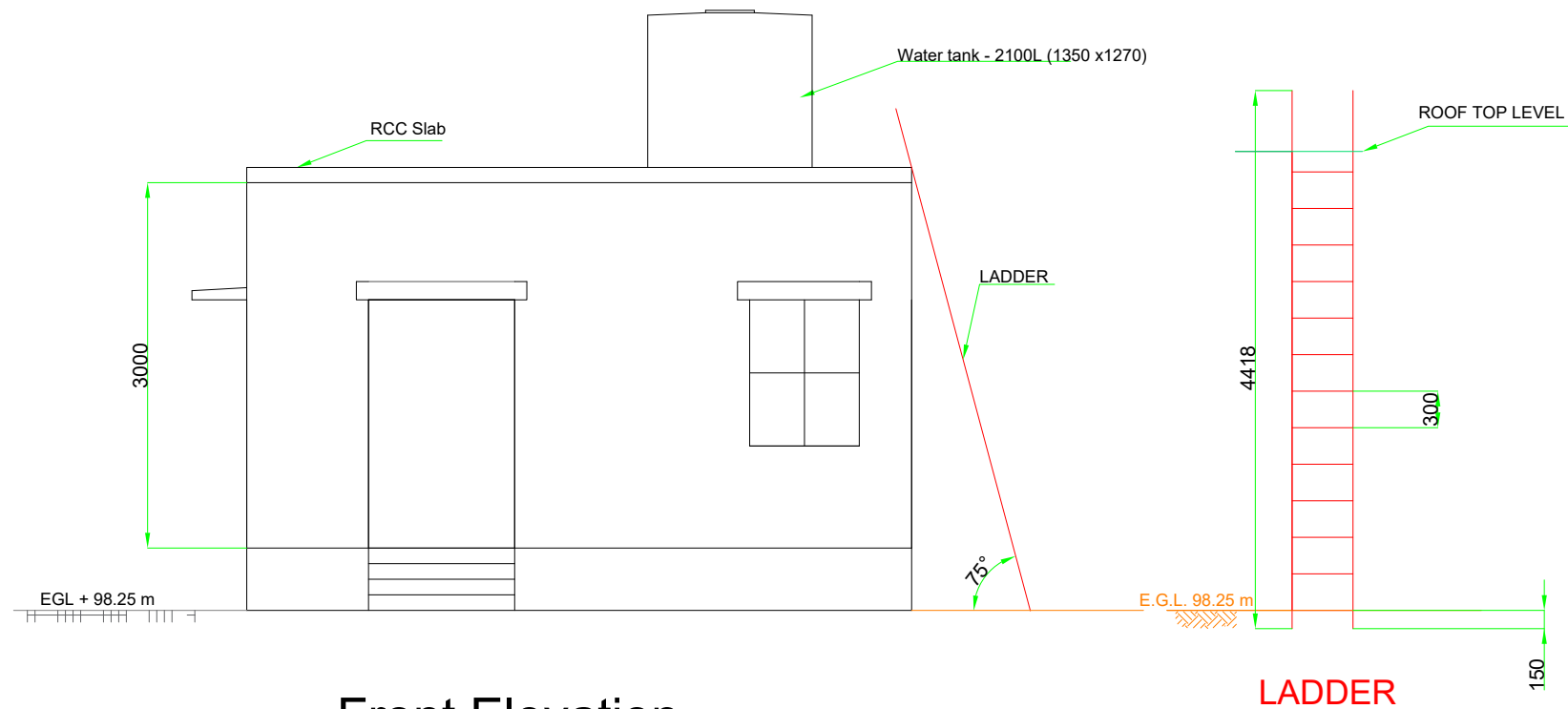

D- Door - 1210 X 2100
 D1- Bathroom door - 800 X 2100
 W- Window - 900 X 1210
 V- Ventilator- 600 X 400
 (500 mm below bottom of the roof)

Front Elevation

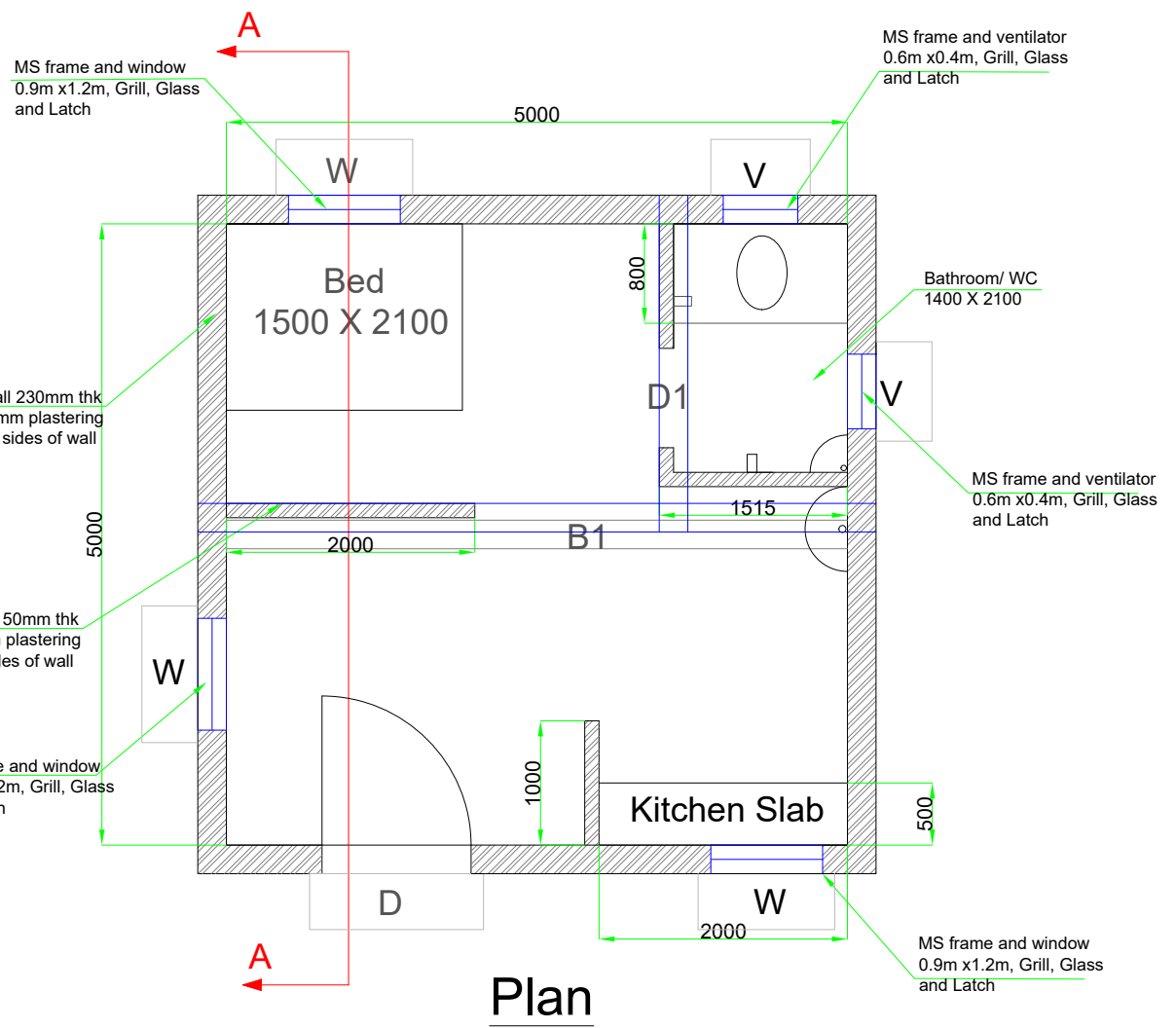

Plan

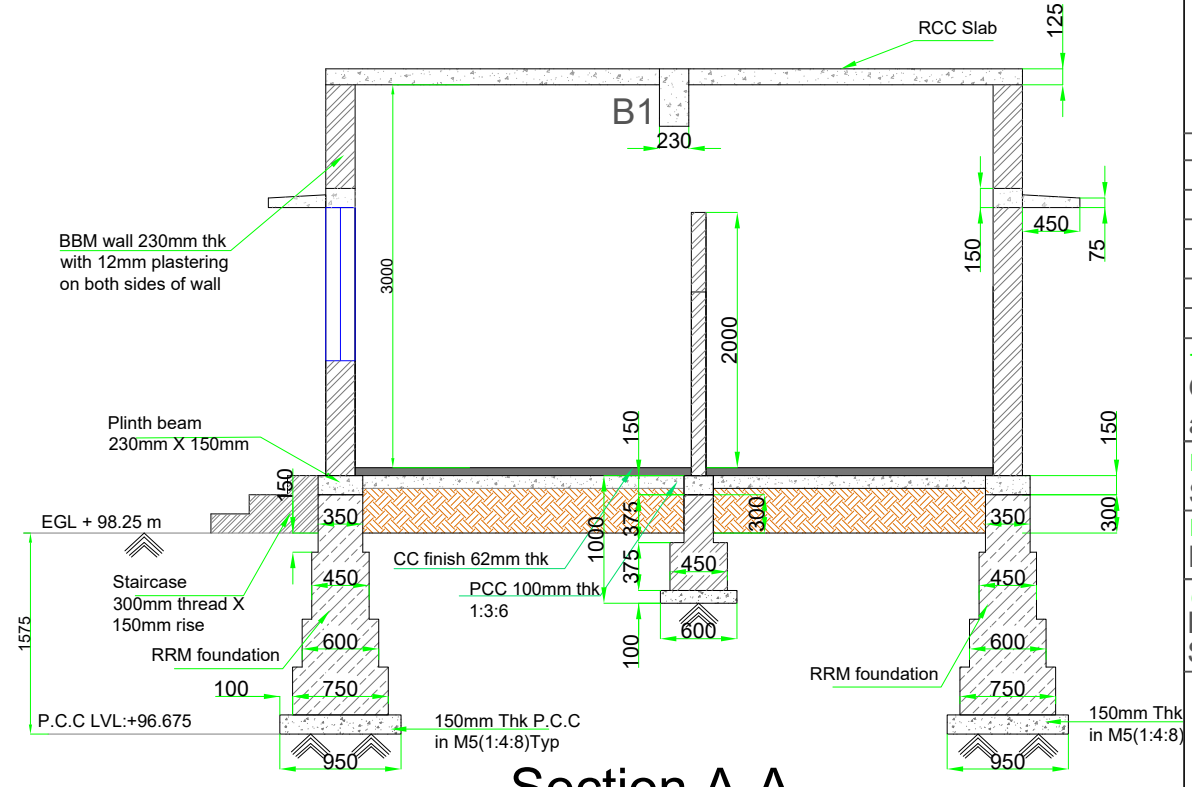

Section A-A

Faecal Sludge Treatment Plant

NOTES

- All dimensions are in 'mm' unless mentioned otherwise.
 - All dimensions are checked and co-related with the architectural drawings and any discrepancy or omission shall be brought to the notice.
 - This is the property of BORDA/CDD & is not to be copied or produced anywhere without their permission.
 - The structural component and BOQ prepared considering Existing Ground Level (+98.25)
 - EGL = Existing Ground Level +98.25
 - FGL = Finished Ground Level
 - HFL = High Flood Level
 - IL/OL = Inlet level/Outlet Level.
- Cement (SRC).
 10. 'R' indicates Register;
 'PDB' indicates Planted Drying Bed
 'UPDB' indicates Unplanted Drying Bed
 'AF' indicates Anaerobic Filter;
 'PGF' indicates Planted Gravel Filter;
 'CT' indicates Collection Tank
 11. Use UPVC pipes (55mm, 110mm & 150 mm dia (2", 4" & 6")) which can withstand pressure of 6kg/cm².
 12. Bench Mark = As per the layout plan provided
 13. Plastering is not considered for the RCC wall structures of PDB, UPDB and Registers
 14. For the details on dimensions of any modules and structures refer to structural drawings. In case of conflict related to dimensions and specifications, structural drawings shall supersede the hydraulic or architectural drawings.

REVISIONS

DATE	REMARKS	SIGNATURE

TITLE
 OPERATOR ROOM: Elevation, Sections and Plan

DRG. No.
 SDL-FSTP-OR-01(Dwg 13 of 21)

PROJECT NAME
 FSTP- Sadul shahar, Rajasthan

CLIENT:
 DLB- Rajasthan and Nagar Palika Sadul shahar

CLIENTS CONSULTANT:
 Consortium for DEWATS Dissemination Society
 Survey No.215, Opp. Beedi Workers Colony, Kommaghatta Road, Bandemath BANGALORE - 560 060 KARNATAKA.

DRAWN BY	CHECKED BY	APPROVED BY
Nithin A.	Praveen N.	Praveen N.
DATE	DATE	DATE
21-02-2121	21-02-2121	21-02-2121
SCALE: NTP	SHEET 13 OF 21 SHEETS	

Faecal Sludge Treatment Plant

NOTES

- All dimensions are in 'mm' unless mentioned otherwise.
- All dimensions are checked and co-related with the architectural drawings and any discrepancy or omission shall be brought to the notice.
- This is the property of BORDA/CDD & is not to be copied or produced anywhere without their permission.
- The structural component and BOQ prepared considering Existing Ground Level (+98.25)
- EGL = Existing Ground Level +98.25
- FGL = Finished Ground Level
- HFL = High Flood Level
- I/L/O L = Inlet level/Outlet Level.
- Cement (SRC).
- 'R' indicates Register;
- 'PDB' indicates Planted Drying Bed
- 'UPDB' indicates Unplanted Drying Bed
- 'AF' indicates Anaerobic Filter;
- 'PGF' indicates Planted Gravel Filter;
- 'CT' indicates Collection Tank
- Use UPVC pipes (55mm, 110mm & 150 mm dia (2", 4" & 6") which can withstand pressure of 6kg/cm².
- Bench Mark = As per the layout plan provided
- Plastering is not considered for the RCC wall structures of PDB, UPDB and Registers
- For the details on dimensions of any modules and structures refer to structural drawings. In case of conflict related to dimensions and specifications, structural drawings shall supersede the hydraulic or architectural drawings.

REVISIONS

DATE	REMARKS	SIGNATURE

TITLE
SLUDGE STORAGE YARD: Sections, Plan and foundation details

DRG. No.
SDL-FSTP-CD-SSY-01(Dwg 15 of 21)

PROJECT NAME
FSTP- Sadul shahar, Rajasthan

CLIENT:
DLB- Rajasthan and Nagar Palika Sadul shahar

CLIENTS CONSULTANT:
 Consortium for DEWATS Dissemination Society
 Survey No.215, Opp. Beedi Workers Colony, Kammaghatta Road, Bandemath BANGALORE - 560 060 KARNATAKA.

DRAWN BY	CHECKED BY	APPROVED BY
Nithin A.	Praveen N.	Praveen N.
DATE	DATE	DATE
21-02-2121	21-02-2121	21-02-2121
SCALE: NTP	SHEET 14 OF 21 SHEETS	

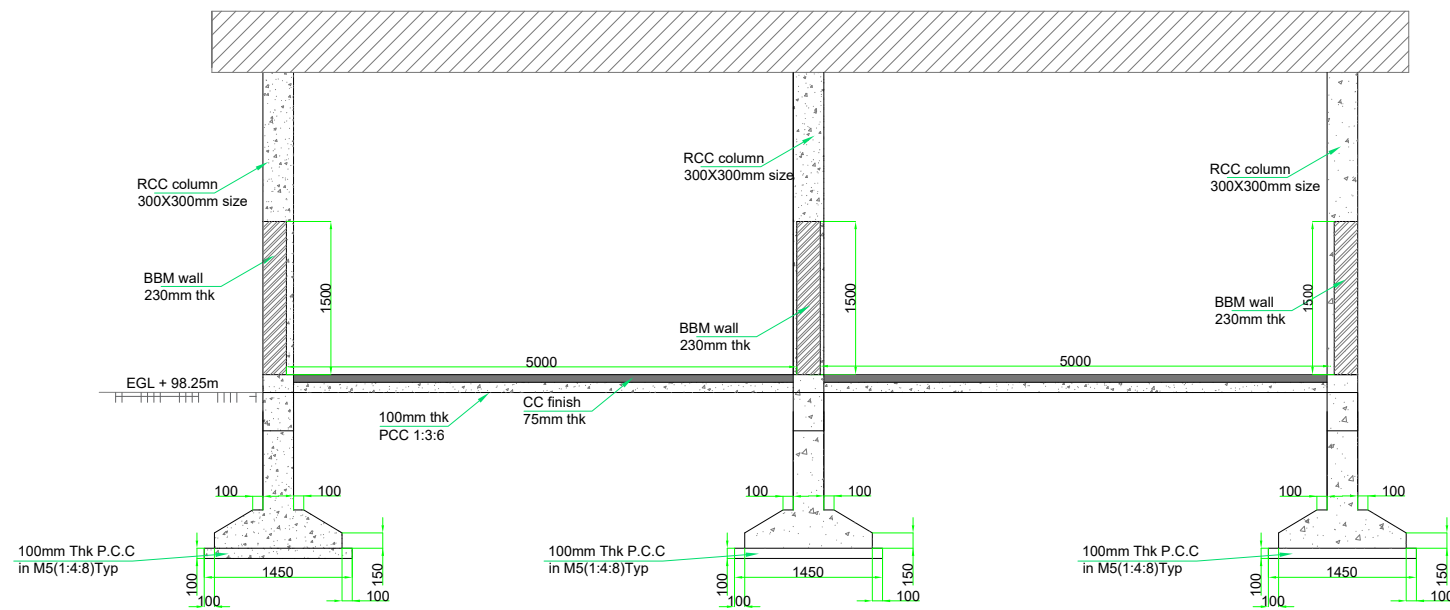

Section A-A

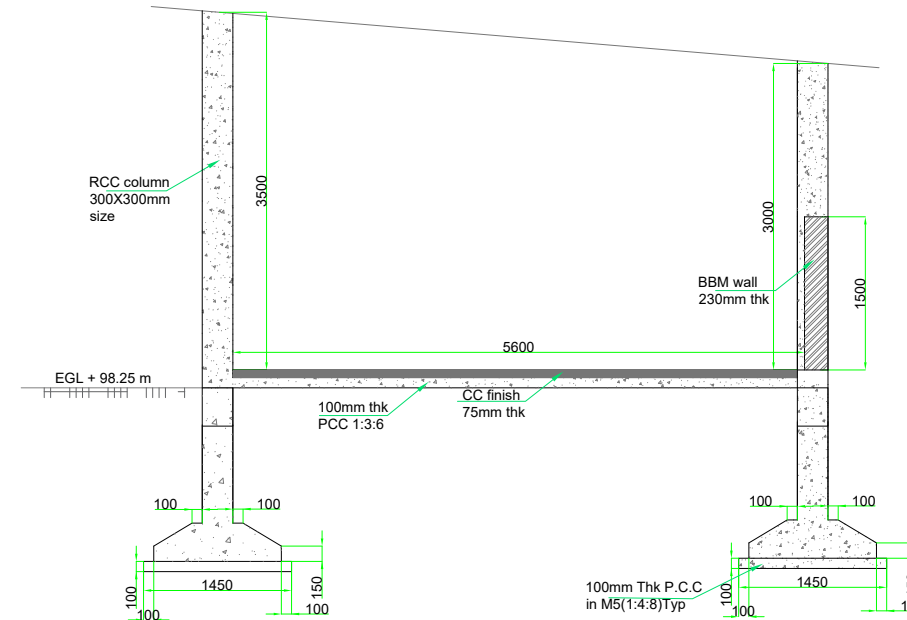

Section B-B

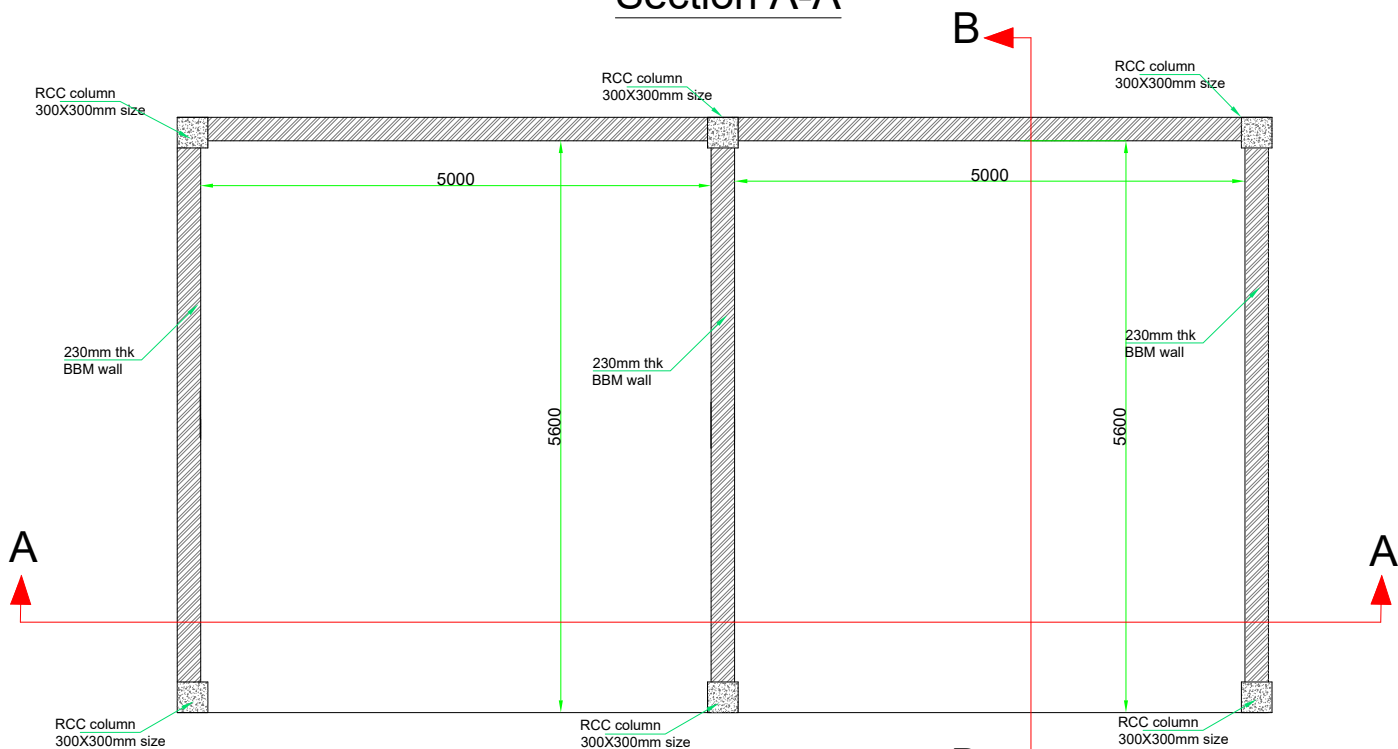

Plan

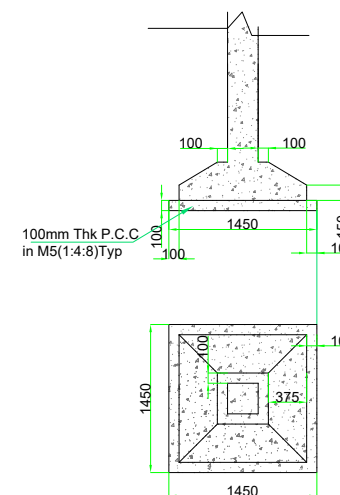

Foundation details

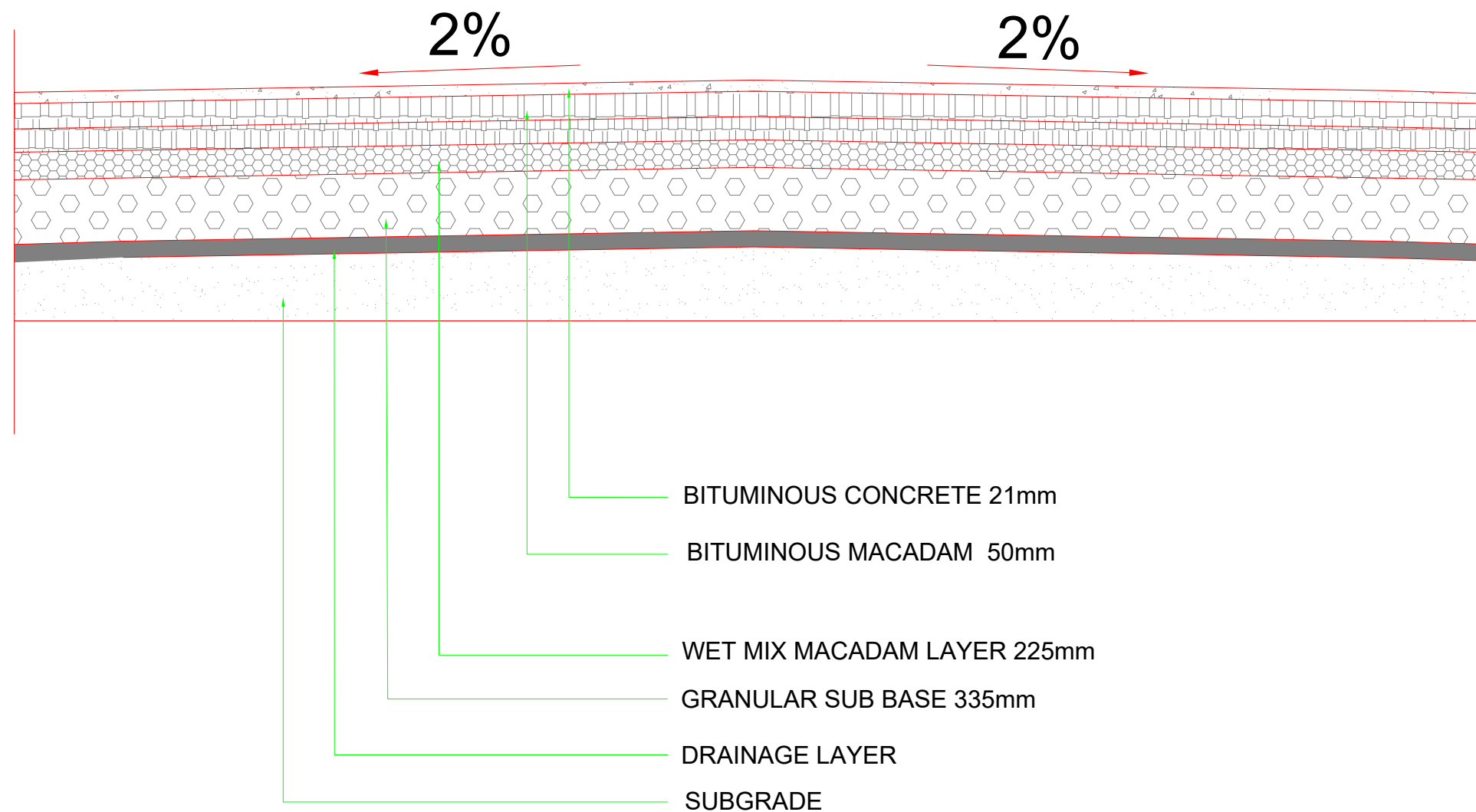

Faecal Sludge Treatment Plant

NOTES

1. All dimensions are in 'mm' unless mentioned otherwise.
2. All dimensions are checked and co-related with the architectural drawings and any discrepancy or omission shall be brought to the notice.
3. This is the property of BORDA/CDD & is not to be copied or produced anywhere without their permission.
4. The structural component and BOQ prepared considering Existing Ground Level (+98.25)
5. EGL = Existing Ground Level +98.25
6. FGL = Finished Ground Level
7. HFL = High Flood Level
8. IL/OL = Inlet level/Outlet Level.
9. Cement (SRC).
10. 'R' indicates Register;
- 'PDB' indicates Planted Drying Bed
- 'UPDB' indicates Unplanted Drying Bed
- 'AF' indicates Anaerobic Filter;
- 'PGF' indicates Planted Gravel Filter;
- 'CT' indicates Collection Tank
11. Use UPVC pipes (55mm, 110mm & 150 mm dia (2", 4" & 6") which can withstand pressure of 6kg/cm².
12. Bench Mark = As per the layout plan provided
13. Plastering is not considered for the RCC wall structures of PDB, UPDB and Registers
14. For the details on dimensions of any modules and structures refer to structural drawings. In case of conflict related to dimensions and specifications, structural drawings shall superseed the hydraulic or architectural drawings.

REVISIONS

DATE	REMARKS	SIGNATURE

TITLE
BITUMINOUS ROAD: Typical Section

DRG. No.
SDL-FSTP-CD-RD-01(Dwg 16 of 21)

PROJECT NAME
FSTP- Sadul shahar, Rajasthan

CLIENT:
DLB- Rajasthan and Nagar Palika
Sadul shahar

CLIENTS CONSULTANT:

Consortium for
DEWATS
Dissemination
Society

Survey No.215,
Opp. Beedi Workers Colony,
Kommaghatta Road, Bandemath
BANGALORE - 560 060
KARNATAKA.

DRAWN BY	CHECKED BY	APPROVED BY
Nithin A.	Praveen N.	Praveen N.
DATE	DATE	DATE
21-02-2121	21-02-2121	21-02-2121
SCALE: NTP	SHEET 15 OF 21 SHEETS	

Faecal Sludge Treatment Plant

NOTES

- All dimensions are in 'mm' unless mentioned otherwise.
 - All dimensions are checked and co-related with the architectural drawings and any discrepancy or omission shall be brought to the notice.
 - This is the property of BORDA/CDD & is not to be copied or produced anywhere without their permission.
 - The structural component and BOQ prepared considering Existing Ground Level (+98.25)
 - EGL = Existing Ground Level +98.25
 - FGL = Finished Ground Level
 - HFL = High Flood Level
 - IL/OL = Inlet level/Outlet Level.
- 9 - Cement (SRC).
 10. 'R' indicates Register.
 'PDB' indicates Planted Drying Bed
 'UPDB' indicates Unplanted Drying Bed
 'AF' indicates Anaerobic Filter.
 'PGF' indicates Planted Gravel Filter.
 'CT' indicates Collection Tank
- Use UPVC pipes (55mm, 110mm & 150 mm dia (2", 4" & 6")) which can withstand pressure of 6kg/cm².
 - Bench Mark = As per the layout plan provided
 - Plastering is not considered for the RCC wall structures of PDB, UPDB and Registers
 - For the details on dimensions of any modules and structures refer to structural drawings. In case of conflict related to dimensions and specifications, structural drawings shall supersede the hydraulic or architectural drawings.

REVISIONS

DATE	REMARKS	SIGNATURE

TITLE
REGISTERS: Sections

DRG. No.
SDL-FSTP-CD-REG-01(Dwg 17 of 21)

PROJECT NAME
FSTP- Sadul shahar, Rajasthan

CLIENT:
DLB- Rajasthan and Nagar Palika
Sadul shahar

CLIENTS CONSULTANT:
 Consortium for DEWATS Dissemination Society
 Survey No.215,
 Opp. Beedi Workers Colony,
 Kormaghatta Road, Bandemath
 BANGALORE - 560 060
 KARNATAKA.

DRAWN BY	CHECKED BY	APPROVED BY
Nithin A.	Praveen N.	Praveen N.
DATE	DATE	DATE
21-02-2121	21-02-2121	21-02-2121
SCALE: NTP	SHEET 16 OF 21 SHEETS	

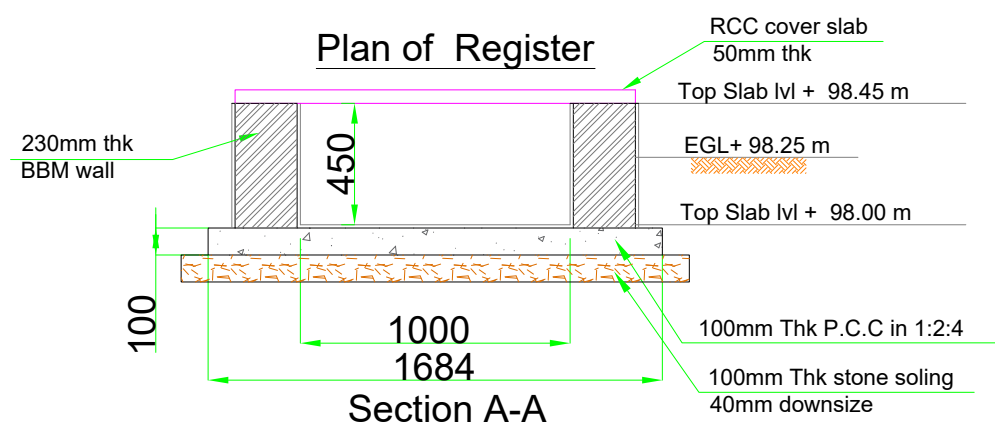
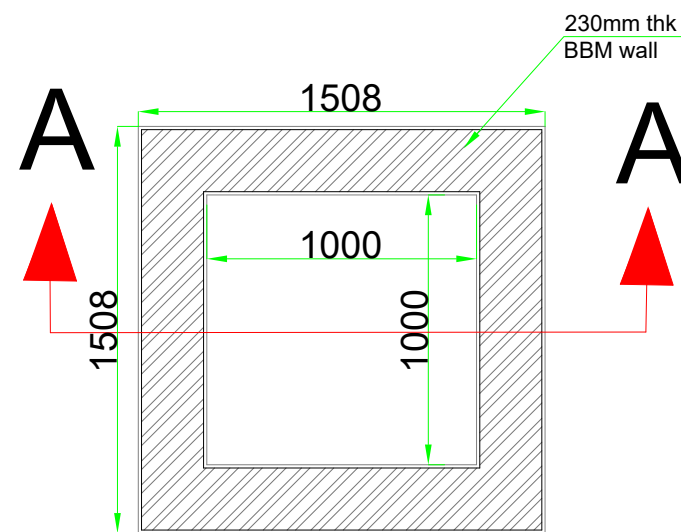
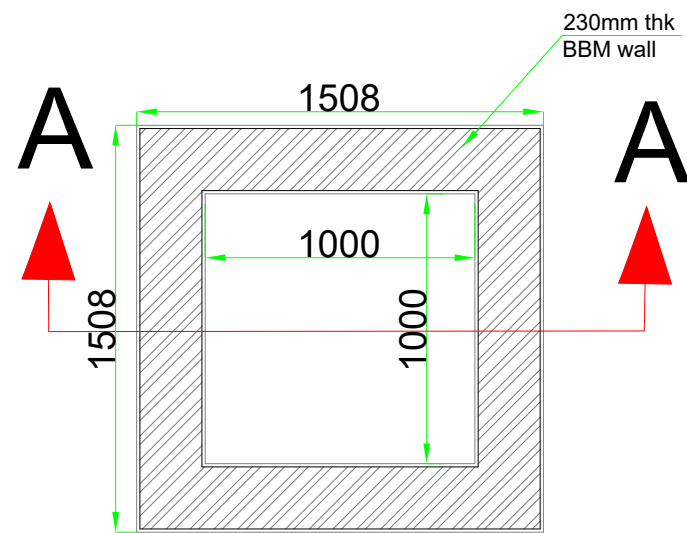

R7

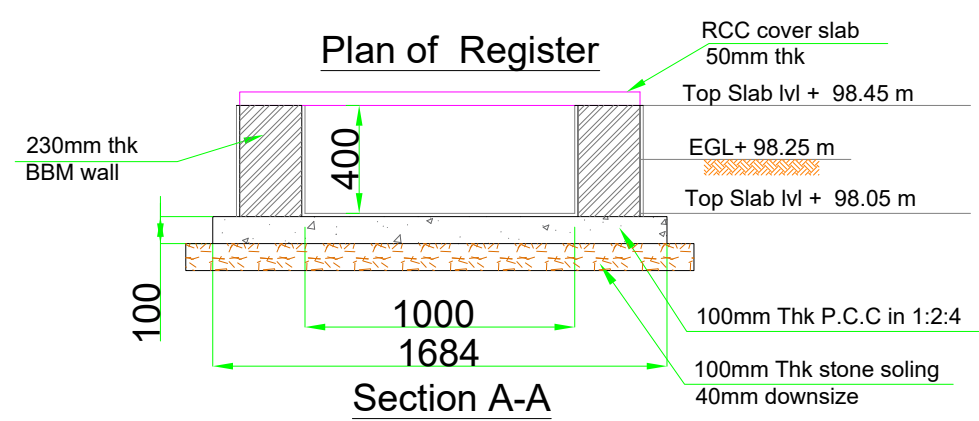

R8 & R9

TOTAL WALL LENGTH: 173m

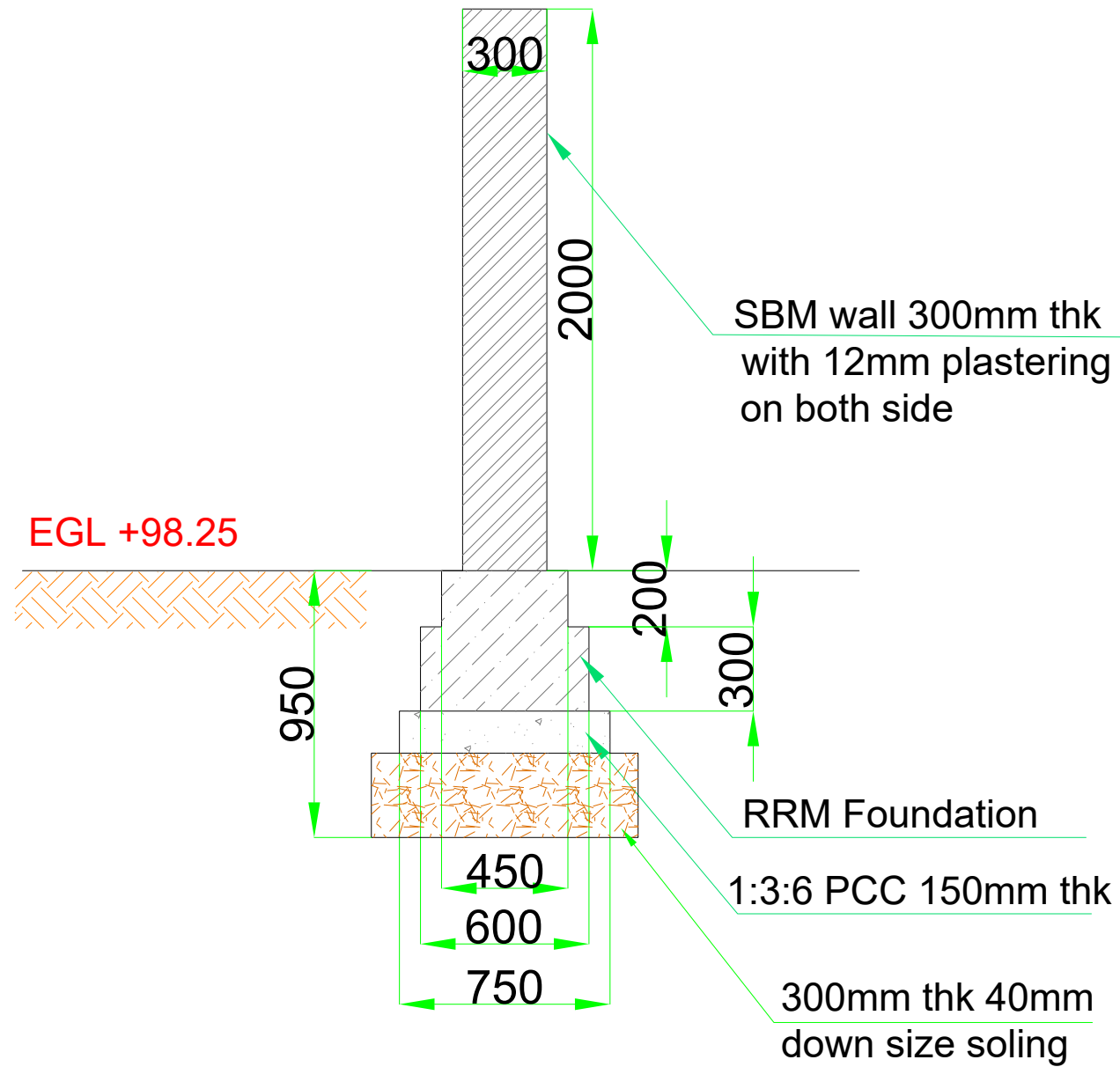

Faecal Sludge Treatment Plant

NOTES

- All dimensions are in 'mm' unless mentioned otherwise.
 - All dimensions are checked and co-related with the architectural drawings and any discrepancy or omission shall be brought to the notice.
 - This is the property of BORDA/CDD & is not to be copied or produced anywhere without their permission.
 - The structural component and BOQ prepared considering Existing Ground Level (+98.25)
 - EGL = Existing Ground Level +98.25
 - FGL = Finished Ground Level
 - HFL = High Flood Level
 - IL/OL = Inlet level/Outlet Level.
- Cement (SRC).
 'R' indicates Register;
 'PDB' indicates Planted Drying Bed
 'UPDB' indicates Unplanted Drying Bed
 'AF' indicates Anaerobic Filter;
 'PGF' indicates Planted Gravel Filter;
 'CT' indicates Collection Tank
 11. Use UPVC pipes (55mm, 110mm & 150 mm dia (2", 4" & 6")) which can withstand pressure of 6kg/cm².
 12. Bench Mark = As per the layout plan provided
 13. Plastering is not considered for the RCC wall structures of PDB, UPDB and Registers
 14. For the details on dimensions of any modules and structures refer to structural drawings. In case of conflict related to dimensions and specifications, structural drawings shall supersede the hydraulic or architectural drawings.

REVISIONS

DATE	REMARKS	SIGNATURE

TITLE
COMPOUND WALL: Section

DRG. No.
SDL-FSTP-CD-CW-01(Dwg 18 of 21)

PROJECT NAME
FSTP- Sadul shahar, Rajasthan

CLIENT:
DLB- Rajasthan and Nagar Palika
Sadul shahar

CLIENTS CONSULTANT:
 Consortium for DEWATS Dissemination Society
 Survey No.215,
 Opp. Beedi Workers Colony,
 Kommaghatta Road, Bandemath
 BANGALORE - 560 060
 KARNATAKA.

DRAWN BY	CHECKED BY	APPROVED BY
Nithin A.	Praveen N.	Praveen N.
DATE	DATE	DATE
21-02-2121	21-02-2121	21-02-2121
SCALE: NTP	SHEET 21 OF 21 SHEETS	



— Existing compound wall
— Proposed compound wall

Faecal Sludge Treatment Plant

NOTES

1. All dimensions are in 'mm' unless mentioned otherwise.
2. All dimensions are checked and co-related with the architectural drawings and any discrepancy or omission shall be brought to the notice.
3. This is the property of BORDA/CDD & is not to be copied or produced anywhere without their permission.
4. The structural component and BOQ prepared considering Existing Ground Level (+98.25)
5. EGL = Existing Ground Level +98.25
6. FGL = Finished Ground Level
7. HFL = High Flood Level
8. IL/OL = Inlet level/Outlet Level.
- 9.
10. 'R' indicates Register;
10. 'PDB' indicates Planted Drying Bed
10. 'UPDB' indicates Unplanted Drying Bed
10. 'AF' indicates Anaerobic Filter;
10. 'PGF' indicates Planted Gravel Filter;
10. 'CT' indicates Collection Tank
11. Use UPVC pipes (65mm, 110mm & 150 mm dia (2", 4" & 6")) which can withstand pressure of 6kg/cm².
12. Bench Mark = As per the layout plan provided
13. Plastering is not considered for the RCC wall structures of PDB, UPDB and Registers
14. For the details on dimensions of any modules and structures refer to structural drawings. In case of conflict related to dimensions and specifications, structural drawings shall supersede the hydraulic or architectural drawings.

REVISIONS

DATE	REMARKS	SIGNATURE

TITLE
COMPOUND WALL: Plan

DRG. No.
SDL-FSTP-CD-CW-02(Dwg 19 of 21)

PROJECT NAME
FSTP- Sadul shahar, Rajasthan

CLIENT:
DLB- Rajasthan and Nagar Palika
Sadul shahar

CLIENTS CONSULTANT:

Consortium for
DEWATS
Dissemination
Society

Survey No.215,
Opp. Beedi Workers Colony,
Kommaghatta Road, Bandemath
BANGALORE - 560 060
KARNATAKA.

DRAWN BY	CHECKED BY	APPROVED BY
Nithin A.	Praveen N.	Praveen N.
DATE	DATE	DATE
21-02-2121	21-02-2121	21-02-2121

SCALE: NTP **SHEET** 21 **OF** 21 **SHEETS**

Faecal Sludge Treatment Plant

NOTES

1. All dimensions are in 'mm' unless mentioned otherwise.
 2. All dimensions are checked and co-related with the architectural drawings and any discrepancy or omission shall be brought to the notice.
 3. This is the property of BORDA/CDD & is not to be copied or produced anywhere without their permission.
 4. The structural component and BOQ prepared considering Existing Ground Level (+98.25)
 5. EGL = Existing Ground Level +98.25
 6. FGL = Finished Ground Level
 7. HFL = High Flood Level
 8. IL/OL = Inlet level/Outlet Level.
9. Cement (SRC).
 10. 'R' indicates Register;
 'PDB' indicates Planted Drying Bed
 'UPDB' indicates Unplanted Drying Bed
 'AF' indicates Anaerobic Filter;
 'PGF' indicates Planted Gravel Filter;
 'CT' indicates Collection Tank
 11. Use UPVC pipes (55mm, 110mm & 150 mm dia (2", 4" & 6")) which can withstand pressure of 6kg/cm².
 12. Bench Mark = As per the layout plan provided
 13. Plastering is not considered for the RCC wall structures of PDB, UPDB and Registers
 14. For the details on dimensions of any modules and structures refer to structural drawings. In case of conflict related to dimensions and specifications, structural drawings shall supersede the hydraulic or architectural drawings.

REVISIONS

DATE	REMARKS	SIGNATURE

TITLE
RAMP EMBANKMENT: Sections

DRG. No.
SDL-FSTP-CD-EMB-01(Dwg 20 of 21)

PROJECT NAME
FSTP- Sadul shahar, Rajasthan

CLIENT:
DLB- Rajasthan and Nagar Palika
Sadul shahar

CLIENTS CONSULTANT:

Consortium for
DEWATS
Dissemination
Society

Survey No.215,
Opp. Beedi Workers Colony,
Kommaghatta Road, Bandemath
BANGALORE - 560 060
KARNATAKA.

DRAWN BY	CHECKED BY	APPROVED BY
Nithin A.	Praveen N.	Praveen N.
DATE	DATE	DATE
21-02-2121	21-02-2121	21-02-2121
SCALE: NTP	SHEET 21 OF 21 SHEETS	

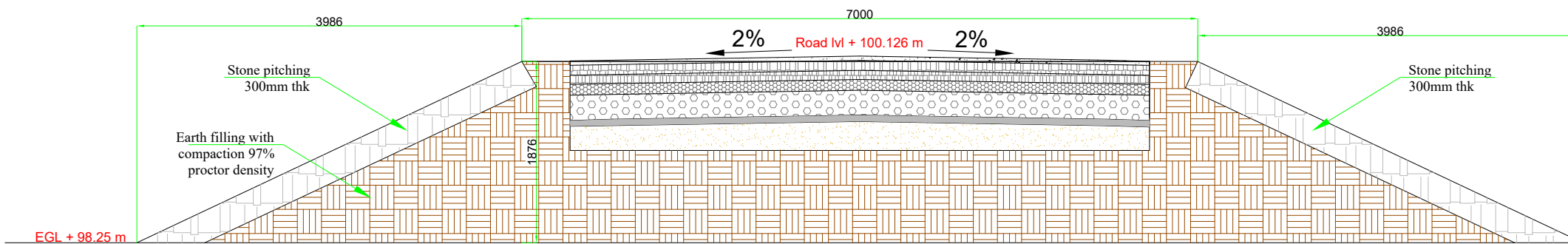

Cross Section of Ramp at Summit

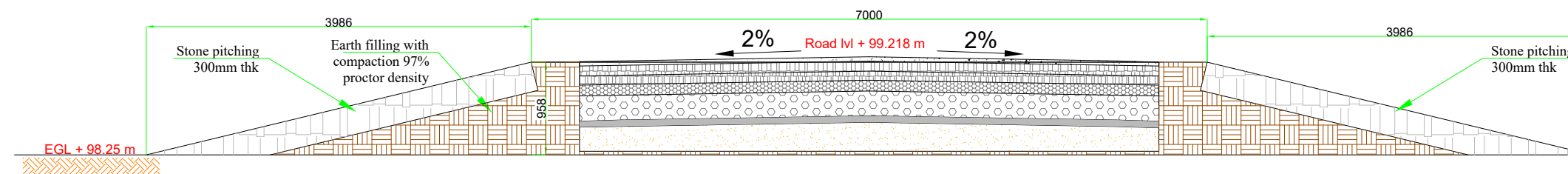

Cross Section of Ramp at half way to summit

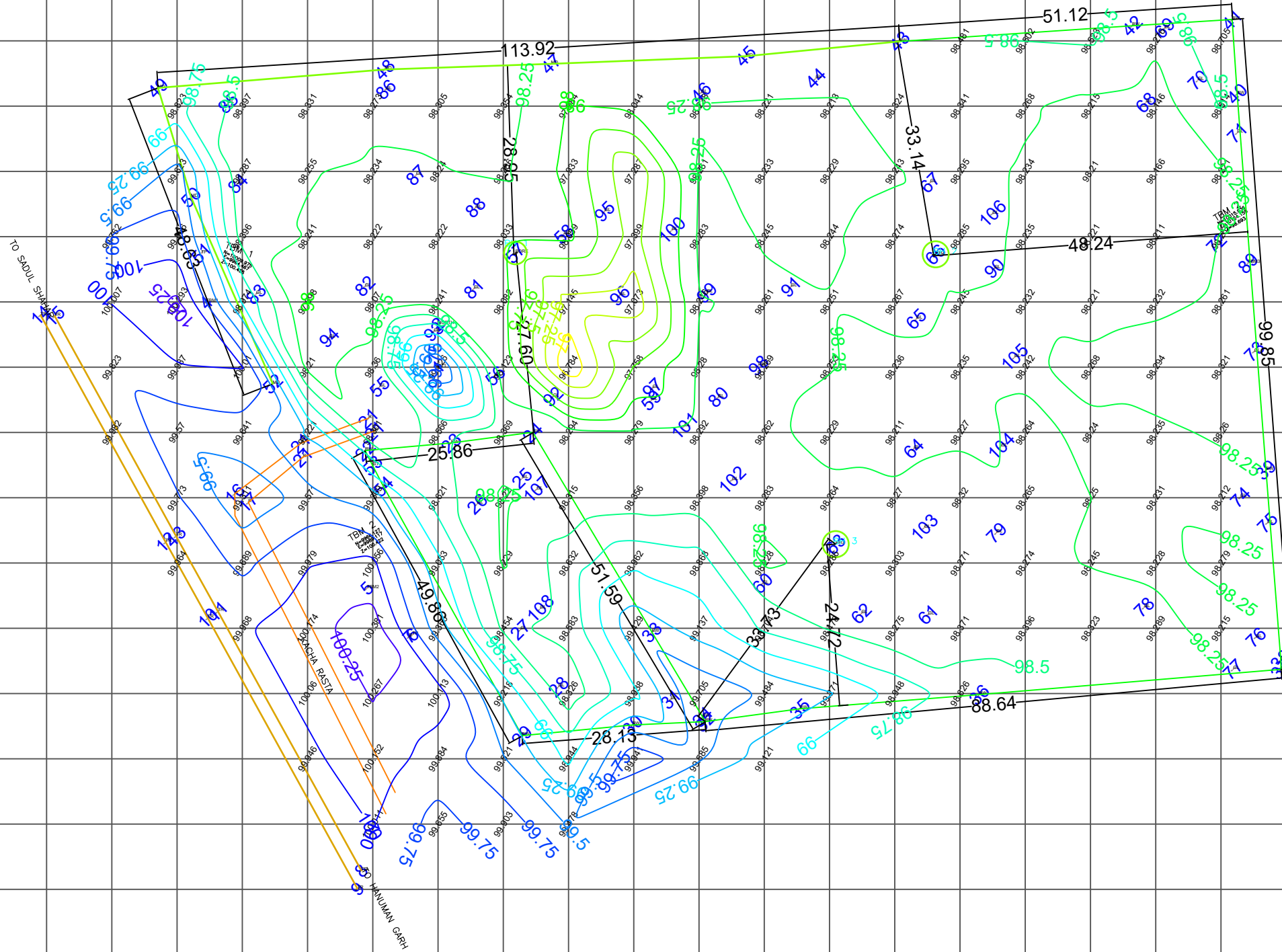

Faecal Sludge Treatment Plant

NOTES

1. All dimensions are in 'mm' unless mentioned otherwise.
2. All dimensions are checked and co-related with the architectural drawings and any discrepancy or omission shall be brought to the notice.
3. This is the property of BORDA/CDD & is not to be copied or produced anywhere without their permission.
4. The structural component and BOQ prepared considering Existing Ground Level (+98.25)
5. EGL = Existing Ground Level +98.25
6. FGL = Finished Ground Level
7. HFL = High Flood Level
8. IL/OL = Inlet level/Outlet Level.
9. Cement (SRC).
10. 'R' indicates Register;
- 'PDB' indicates Planted Drying Bed
- 'UPDB' indicates Unplanted Drying Bed
- 'AF' indicates Anaerobic Filter;
- 'PGF' indicates Planted Gravel Filter;
- 'CT' indicates Collection Tank
11. Use UPVC pipes (65mm, 110mm & 150 mm dia (2", 4" & 6")) which can withstand pressure of 6kg/cm².
12. Bench Mark = As per the layout plan provided
13. Plastering is not considered for the RCC wall structures of PDB, UPDB and Registers
14. For the details on dimensions of any modules and structures refer to structural drawings. In case of conflict related to dimensions and specifications, structural drawings shall supersede the hydraulic or architectural drawings.

LEGEND

C.C ROAD	BT ROAD	TUBE WELL
WBM ROAD	WBM ROAD	WATER LINE PIPE
BUILDING	K.RASTA	HT POLE
K.RASTA	K.RASTA	ESR(TANK)
CENTER LINE	---	LT POLE
TBM	---	SIGNAL POLE
E.P BOX	---	SIGN BOARD
CLUVERT	---	TEEN SHED
FIELD BOUNDARY	---	TELEPHONE POLE
DIVIDER	DIVIDER	TANSFORMER
STOP	---	TREE
B.T ROAD	B.T ROAD	WATER TANK
E.P. LINE	---	WELL
L.T. LINE	---	TEMPAL
FENCING	---	ELECTRIC POLE
FOOT PATH	FOOT PATH	LAMP POST
GATE	---	MAIN HOLE
H.T. LINE	---	HAND PUMP
PROJECT TOPOGHARAPICAL SURVEY SADULSHAR		Surveyed By MEGHRAJ CONSTRUCTION 77A USHA VIHAR TIRUVENI NAGAR GORPALPURA BY PASS, Jajpur - 302121 Ph.7742969777 email:-meghrajconstruction@gmail.com

REVISIONS

DATE	REMARKS	SIGNATURE

TITLE
Topography map- FSTP site- Sadulshahar

DRG. No.
SDL-FSTP-TOPO-01(Dwg 21 of 21)

PROJECT NAME
FSTP- Sadul shahar, Rajasthan

CLIENT:
DLB- Rajasthan and Nagar Palika
Sadul shahar

CLIENTS CONSULTANT:
 Consortium for DEWATS Dissemination Society
 Survey No.215,
 Opp. Beedi Workers Colony,
 Kommaghatta Road, Bandemath
 BANGALORE - 560 060
 KARNATAKA.

DRAWN BY	CHECKED BY	APPROVED BY
Nithin A.	Praveen N.	Praveen N.

DATE	DATE	DATE
21-02-2121	21-02-2121	21-02-2121

SCALE: NTP **SHEET** 21 **OF** 21 **SHEETS**